

**Dometic®**  
**Gravity-Discharge Toilets**  
**INSTRUCTION MANUAL**

**IMPORTANT NOTICE**

Dometic® toilet systems must be installed according to Dometic's recommended procedures.



**WARNING**

**This manual must be read and understood before adjustment, maintenance, or service is performed. Modification of this product can result in property damage.**

## Important Information Before Operation

1. Do not use chlorine or caustic chemicals, such as laundry bleach or drain-opening types, in the system. These products damage the seals in toilets and dump valves.
2. Do not permit foreign objects (paper towels, paper cups, diapers, sanitary napkins, etc.) to be flushed through the toilet.
3. Mechanical seal toilets, like Dometic units, are designed to only discharge directly into a holding tank. Horizontal pipe runs as found in conventional residential or commercial plumbing systems cannot be accommodated.
4. Toilet bowl must be regularly cleaned and winterized according to "Cleaning" and "Winterization and Storage" procedures or your warranty coverage may be voided.

## Toilet Model Identification

The model identification label is located on the toilet base and will show the model number and serial number. For model 210 and 510H toilets, remove base cover to locate identification label (see next page).

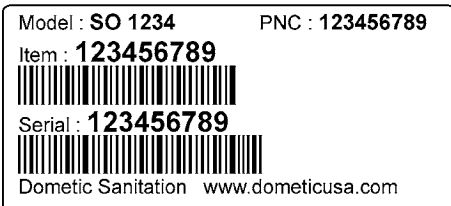

## Operation

To prepare the Dometic toilet for use, check to be sure water supply to the toilet is connected. Turn on water supply and check system for leaks. Flush toilet and check for leaks.

To properly use the Dometic toilet, follow these simple instructions:

1. **To add water to the toilet**, lift or raise the flush pedal until desired water level is reached. Generally, more water is required only when flushing solids.
2. **To flush toilet**, push pedal all the way down until contents leave toilet bowl. Water flow pressures vary at different locations, therefore holding the flush pedal down for 4-8 seconds may be required. Minimum flow at the toilet of two gpm (7.6 lpm) is required for proper rim and bowl wash.
3. Release flush pedal by allowing it to snap back, which permits positive sealing around the flush ball.
4. A small amount of water should remain in bowl.

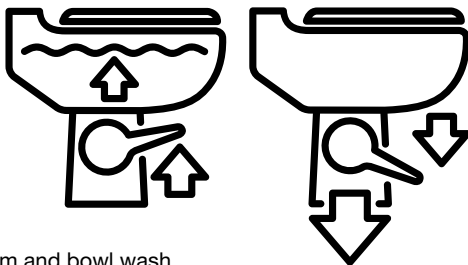

### Note

Holding flush pedal down longer than necessary results in excessive water use.

# Installation

1. To replace an older toilet, turn off water supply to toilet. Disconnect water line at toilet water valve. Unscrew floor bolt nuts and remove toilet. Discard old floor seal and mounting bolts. The old floor flange may be used if it is in good condition and fastener holes are positioned as shown in Figure A. Make sure center of floor flange is at least 11 inches from back wall (Figure A).
2. If installing new floor flange, make certain that the toilet mounting bolts align properly with Dometic toilet mounting pattern (Figure B).
3. Secure flange to floor using at least four flat-head screws (one each at the front, back, right and left sides of flange) through countersunk holes. Insert floor bolts into slotted holes at right and left sides of flange (Figure B).
4. Position floor seal by pressing the floor bolts up through holes in the seal.
5. Set toilet in place with bolts protruding up through mounting holes in base (Figure C).
6. Install washers and hex nuts provided with toilet. Snug nuts down equally with standard 7/16-inch open end wrench. Install two wood screws provided in two holes at rear of base (Figure C).
7. If toilet is being installed in a shower stall, apply a 1/4-inch bead of glazing compound around the perimeter of the base (Figure D).
8. Connect water supply line to water valve (1/2 in. NPT) inlet using appropriate fittings or an extension (Figure E).
9. Turn on water supply and flush toilet to test for leaks.
10. Attach pedal cover to flush pedal (see instructions below) after making sure there are no leaks at connections.
11. FOR MODEL 210, put base cover in front of toilet base, aligning flush pedal with opening on side of cover. Push base cover against front of base, making sure it does not interfere with flush pedal operation (Figure F).

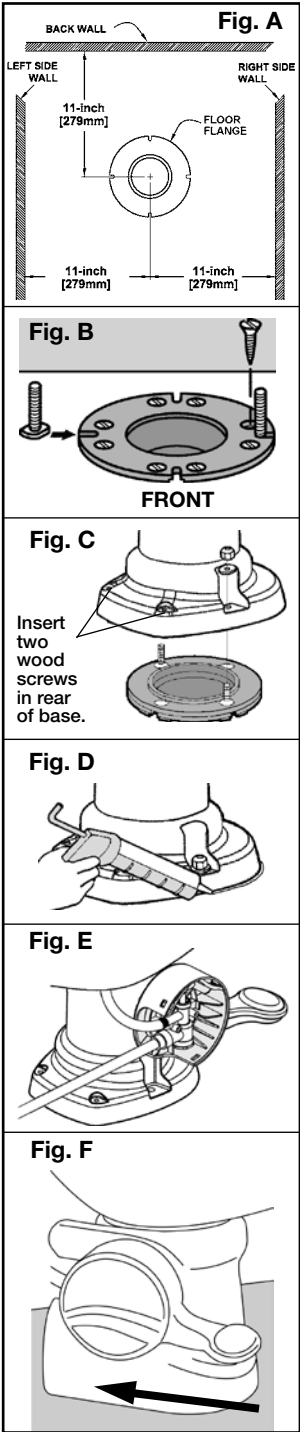

FOR MODEL 510H, attach base cover to toilet base in same manner for model 210, then fasten two sides together in back of base using elastic bands.

## Attaching Pedal Cover

1. Align cover with pedal and press into place so that tab locks into space at rear of pedal.
2. To release cover, press on tab at back of pedal and pull off.

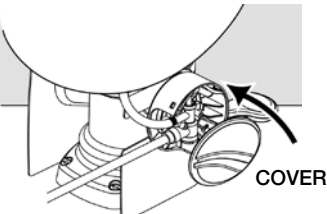

## Cleaning

**BOWL CLEANING:** For routine cleaning, use SeaLand® Toilet Bowl Cleaner (Fig. A). If this SeaLand cleaner is not available in your area, use most any non-abrasive bathroom and toilet bowl cleaner (Bar Keeper's Friend® spray cleaner, Clorox® toilet bowl cleaner, SaniFlush® toilet bowl cleaner, etc.). Please follow label instructions.

To avoid damaging the seal, **DO NOT USE:**

- abrasives (Comet®, Soft Scrub® cleansers, etc.)
- caustic chemicals (Drano® clog remover, etc.)
- lubricants and cleaners containing alcohols or petroleum distillates (Pam® cooking spray, Pine-Sol® cleaner, WD-40® lubricant, etc.).



**FLUSH BALL CLEANING:** After a period of time, mineral deposits from hard water may build up on the flush ball or seal, resulting in a slow water leak. To prevent this, periodically clean the flush ball and seal.

1. Remove minor debris from the flush ball and seal by slowly pressing and releasing the flush pedal several times. This will loosen and rinse debris from the surfaces. Repeat several times for stubborn buildup.
2. If step 1 does not fully clean the ball and seal, clean with a soft bristle brush and SeaLand Toilet Bowl Cleaner. Turn off water supply to toilet. Fully clean the top of the flush ball and under the seal where it contacts the flush ball.
3. After cleaning underside of seal, apply light downward pressure to top of seal while brushing around full perimeter of seal.
4. Turn on water supply. Press flush lever to open flush ball, and use brush and water to rinse away cleanser and loosened deposits.

® Bar Keepers Friend is a registered trademark of SerVaas Laboratories Inc.

® Clorox, Pine-Sol and Soft Scrub are registered trademarks of The Clorox Co.

® Comet is a registered trademark of Prestige Brands International.

® Drano is a registered trademark of S.C. Johnson & Son Inc.

® Pam is a registered trademark of ConAgra Foods.

® SaniFlush is a registered trademark of Reckitt Benckiser Inc.

® Teflon is a registered trademark of DuPont Co.

® WD-40 is a registered trademark of WD-40 Company.

## Winterization and Storage

When a Dometic toilet is stored for long periods of time or may be exposed to temperatures below freezing, the toilet must be winterized or stored according to one of the following procedures.



### Caution

This toilet is not intended for use when exposed to temperatures below freezing.



### Caution

Never use automotive-type antifreeze (ethylene glycol) in freshwater systems.



### Note

Use nontoxic antifreeze (propylene glycol) designated for potable water systems. (See vehicle owner's manual.)

## Storage options

### Non-toxic Antifreeze Winterization (recommended method)

1. Pour antifreeze in potable water tank according to instructions from antifreeze manufacturer.
  2. Flush toilet several times until antifreeze has flowed completely through toilet. For toilets with hand sprayer, the hand sprayer must be turned on to assure antifreeze is cycled through the sprayer.
- (continued on next page)*

## Drain Water from Toilet

1. Turn off water supply to toilet.
2. Remove water supply line from water valve.
3. Place a small container under water valve inlet to catch draining water.
4. Press flush pedal and allow water to completely drain from water valve and vacuum breaker.
5. Leave water line disconnected until threat of freezing temperature is past.



### Note

Never leave vehicle or premises unoccupied for extended periods of time with municipal water supply or onboard water pump turned on when there is a possibility of freezing temperature.

---



### Caution

Toilet warranty does not cover freeze damaged water valve that may result from improper winterization.

---

## Deodorants and Special Tissue

Your Dometic toilet requires the regular addition of a deodorant product to reduce malodors and to help break down holding tank contents. Several factors should be considered in selecting a deodorant product.

**Liquid or Granulated.** Liquid products work more quickly by readily going into solution. Granulated powder formulations have the advantage of requiring less storage space and are less likely to leak if the package is inadvertently damaged.

**How Much Deodorant and How to Add It.** The deodorant is added directly into the toilet bowl, then flushed into the holding tank. Follow bottle or package instructions. Conditions of extremely warm weather, longer waste holding time and larger tank capacities may require more deodorant treatment. Also, to maintain optimum efficiency in odor control, the waste holding tank should be cleaned thoroughly at least once or more each season depending on use.

**Why Not Use Household Toilet Paper in Your Toilet.** Household tissues often contain adhesives which bond together the paper fibers from which the tissue is made. The adhesives prevent the tissue from breaking apart, and their use in “ultra-low flow” systems can cause system clogging. SeaLand tissue is especially designed for use in low water toilet systems. Its rapid dissolving properties minimize the amount of residual paper in the holding tank and allow deodorizers to work more efficiently.

**SeaLand and Dometic Brands versus Other Brands.** We constantly strive to provide our system owners with effective products that have minimal environmental impact and good value. Many deodorant products do not measure up to our standards of performance and value.

# Troubleshooting Guide

## Dometic toilet base assembly

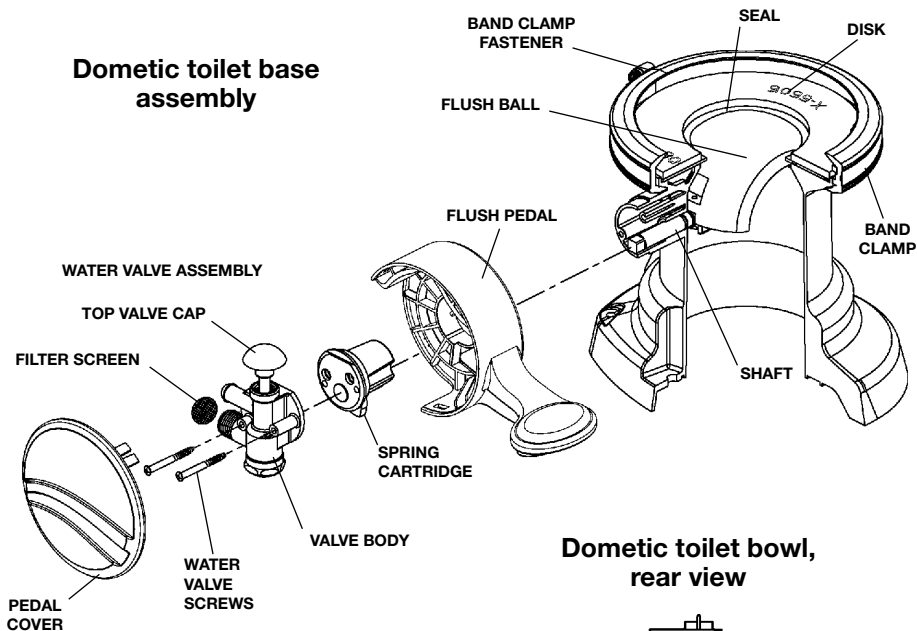

## Dometic toilet bowl, rear view

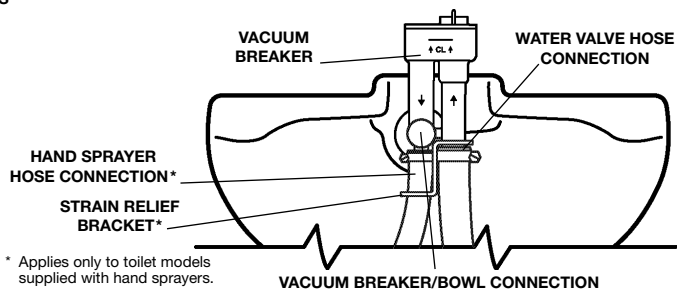

Problem	Possible Cause	Service Instruction
1. Toilet emits odor (flush ball open).	a. Odor emitting from base of toilet. b. Plugged holding tank vent line.	a. Use SeaLand brand deodorants. b. Clear obstruction from vent line.
2. Water will not stay in bowl.	a. Loose band clamp. b. Improper seal around flush ball due to dirt or debris on flush ball. c. Worn or damaged seal. d. Worn or damaged flush ball.	a. Tighten band clamp fastener. b. Inspect flush ball for foreign debris. Clean flush ball if needed. c. Replace seal. d. Replace flush ball.

<b>Problem</b>	<b>Possible Cause</b>	<b>Service Instruction</b>
3. Flush ball will not close completely.	a. Too much friction between flush ball and ball seal. b. Water valve screws are too tight. c. Defective spring cartridge.	a. Lubricate between flush ball and seal with lubricant (e.g. silicone spray, furniture polish). b. Loosen screws slightly. c. Check spring tension by pushing flush lever down, then release it suddenly. If lever does not snap back to original position, replace spring cartridge.
4. Flush ball will not open.	a. Broken shaft. b. Shaft not fully engaged in the spring cartridge.	a. Replace shaft. b. Rotate flush ball slightly until shaft lines up with square in spring cartridge and is fully engaged.
5. Water does not shut off in toilet (toilet overflows).	a. Worn or defective water valve. b. Worn or defective spring cartridge.	a. Replace water valve. b. Replace spring cartridge.
6. Hand sprayer leaks.	a. Hand sprayer is defective.	a. Replace hand sprayer.
7. Water does not enter toilet bowl properly.	a. Insufficient water flow rate at toilet. b. Water valve clogged. c. Plugged rim wash holes in toilet.	a. Check water flow rate at toilet. Rate should be 2 gpm (7.6 lpm) at toilet. b. Remove and clean screen located on water valve. c. Clean holes. If still a problem, replace toilet bowl.
8. Water is leaking from water valve.	a. Water valve body cracked due to freeze damage. b. Water line connection is loose or not seated properly. c. Defective water valve. d. Stripped threads.	a. Replace water valve. b. Insure that threads are not cross-threaded and tighten. c. Replace water valve. d. Replace water valve.
9. Water is leaking from bottom of toilet base.	a. Toilet is not secured to floor. b. Worn or defective toilet mounting floor seal. c. Cracked base. d. Worn or defective floor flange.	a. Tighten toilet mounting bolts. b. Replace floor seal between floor flange and toilet base. c. Replace base assembly. d. Replace floor flange.
10. Water is leaking from rear of toilet.	a. Loose vacuum breaker. b. Damaged or defective vacuum breaker. c. Cracked or defective toilet bowl.	a. Make sure vacuum breaker stem is pushed fully into sealing grommet in back of bowl. b. Remove white cap from vacuum breaker. Flush toilet. If water leaks during flush, vacuum breaker needs to be replaced. c. Replace toilet.
11. Water is leaking from the base/toilet connection.	a. Band clamp may be loose. b. Ball/bowl seals may be worn or defective.	a. Remove plastic base cover (on applicable models) and tighten band clamp fastener. b. Replace ball/bowl seals.

## Manufacturer's 2-year and 10-year Limited Warranty

Dometic Corporation warrants, to the original purchaser only, that this Dometic® gravity discharge toilet, if used for personal, family or household-like purposes, is free from defects in material and workmanship for a period of two (2) years from the date of purchase.

Dometic also warrants, to the original purchaser only, that the ceramic portion of the toilet bowl will not discolor, stain, scratch or craze for a period of ten (10) years if used for personal, family or household-like purposes, and is regularly cleaned as described in the product owner's manual.

If this Dometic product is placed in commercial or business use, it will be warranted, to the original purchaser only, to be free of defects in material and workmanship for a period of ninety (90) days from the date of purchase.

Dometic reserves the right to replace or repair any part of this product that proves, upon inspection by Dometic, to be defective in material or workmanship. All labor and transportation costs or charges incidental to warranty service are to be borne by the purchaser-user.

### EXCLUSIONS

IN NO EVENT SHALL **DOMETIC** BE LIABLE FOR INCIDENTAL OR CONSEQUENTIAL DAMAGES, FOR DAMAGES RESULTING FROM IMPROPER INSTALLATION, OR FOR DAMAGES CAUSED BY NEGLIGENCE, ABUSE, ALTERATION, OR USE OF UNAUTHORIZED COMPONENTS. THIS INCLUDES FAILURES WHICH MAY RESULT FROM NOT FOLLOWING THE WINTERIZATION OR CLEANING PROCEDURES AS DESCRIBED IN THIS OWNER'S MANUAL. ALL IMPLIED WARRANTIES, INCLUDING ANY IMPLIED WARRANTY OF MERCHANTABILITY OR FITNESS FOR ANY PARTICULAR PURPOSE, ARE LIMITED TO A PERIOD OF ONE (1) YEAR FROM DATE OF PURCHASE.

### IMPLIED WARRANTIES

No person is authorized to change, add to, or create any warranty or obligation other than that set forth herein.

Implied warranties, including those of merchantability and fitness for a particular purpose, are limited to one (1) year from the date of purchase for products used for personal, family or household-like purposes, and ninety (90) days from the date of purchase for products placed in commercial or business use.

### OTHER RIGHTS

Some states do not allow limitations on the duration of an implied warranty, and some states do not allow exclusions or limitations regarding incidental or consequential damages; so, the above limitations may not apply to you. This warranty gives you specific legal rights, and you may have other rights which vary from state to state.

To obtain warranty service, first contact the local dealer from whom the product was purchased.

Dometic Group is a customer-driven, world-leading provider of leisure products for the caravan, motorhome, automotive, truck and marine markets. We supply the industry and aftermarket with a complete range of air conditioners, refrigerators, awnings, cookers, sanitation systems, lighting, mobile power equipment, comfort and safety solutions, windows, doors and other equipment that make leisure life more comfortable away from home.

Dometic Group supplies a wide range of workshop equipment for service and maintenance of built-in air conditioning. Dometic Group also provides specially designed refrigerators for hotel rooms and offices, for transport and storage of medical products, and for storing wine.

Our products are sold in almost 100 countries and are produced mainly in wholly owned production facilities around the world. The number of employees is 6,000.

