

EGS BACKER LAYOUT

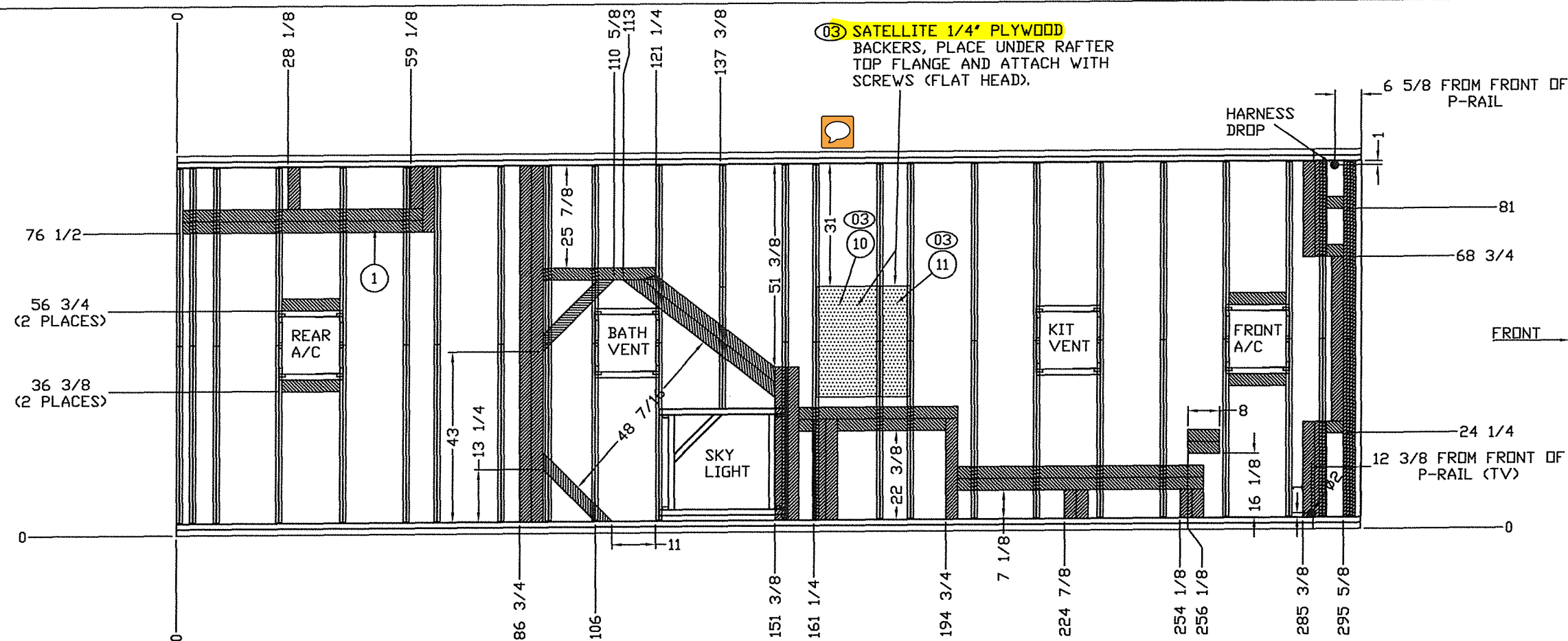

A/C DUCT LAYOUT

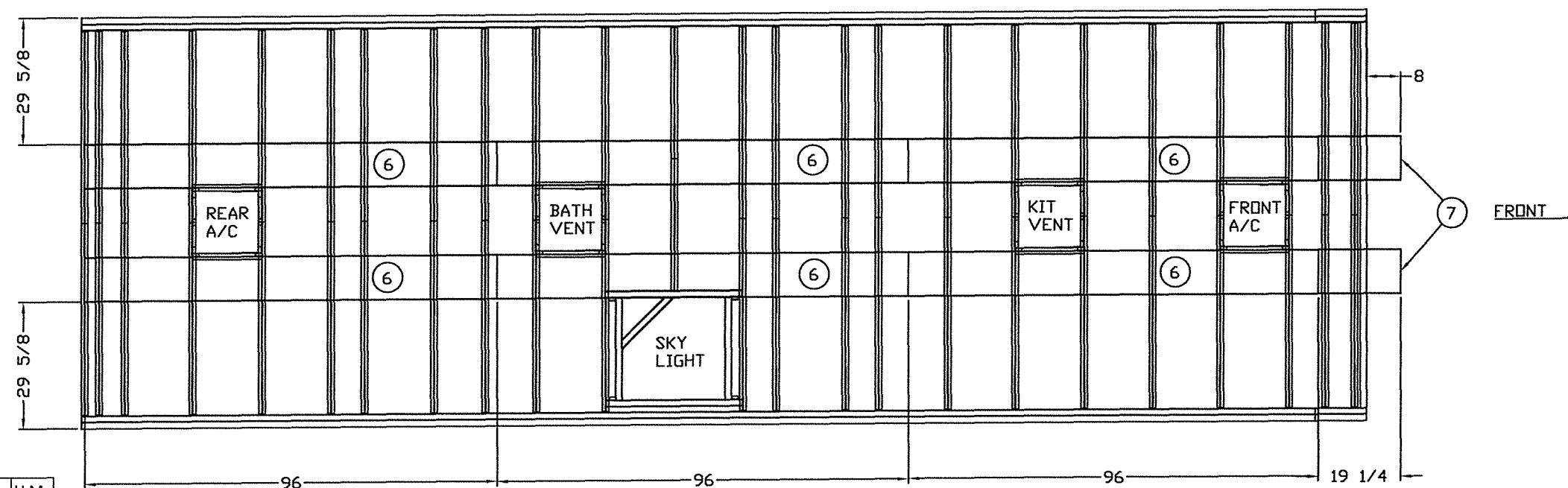

ITEM	QTY.	DESCRIPTION	LENGTH	TOTAL	U.M.
1	1	EGS BACKER, 3 x 88 x 28GA.	1688	140.67	LF
6	6	ROOF, A/C DUCT, 1-7/8 x 10-1/4 x 96	96	6.00	EA
7	2	ROOF, A/C DUCT, 1-7/8 x 10-1/4 x 96	19 1/4	0.40	EA
				6.40	EA

ITEM	QTY.	DECIPTION	LENTH	X	WIDTH	TOTAL	U.M.
10	1	PLYWOOD, 48 x 96 x 1/4"	28	X	23 11/16	4.61	SF
12	1	PLYWOOD, 48 x 96 x 1/4"	28	X	7 1/2	1.46	SF
TOTAL						6.06	SF

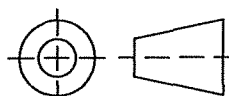

DENOTES CRITICAL ITEM

DYNAMAX, A DIVISION OF FOREST RIVER CLAIMS
PROPRIETARY RIGHTS IN THE MATERIAL DISCLOSED
HEREON. NEITHER THIS DRAWING NOR ANY REPRODUCTION
THEREOF MAY BE USED TO MANUFACTURE ANYTHING
SHOWN HEREON WITHOUT PERMISSION IN WRITING FROM
DYNAMAX TO THE USER SPECIFICALLY REFERRING TO THE
DRAWING.

TOLERANCE UNLESS
SPECIFIED OTHERWISE

FRACTION	+0- $\frac{1}{16}$
PLC, DEC.	$\pm .06$
PLC, DEC.	$\pm .03$
PLC, DEC.	$\pm .01$
ANGULAR	$\pm 1^{\circ}$

SIZE
B

MODEL

ISATA 5, 36DS	D04020300
---------------	-----------



DYNAMAX

(PLANT #55) 2745 NORTHLAND DRIVE ELKHART, IN. 46514

[illegible]

ASSEMBLY, MAIN ROOF

DRAWN BY

DATE _____

05/29/2015

APPR

SHEE

3 OF 4

REV

DWG NO.	
---------	--

D04020300

03

(03)

NOTE:

WIRE LOCATION FOR PREP ONLY.
WIRING SHOULD BE LEFT IN THE ROOF
AT THIS LOCATION WHICH SHOULD BE
ABOVE A RECESSED LIGHT.
THE SATELLITE DUE TO THE LINE OF SIGHT
REQUIREMENTS NEEDS TO BE IN THIS LOCATION.
SOLAR PANELS CAN BE RELOCATED IF NEED BE AS
THE CABLING PERMITS.

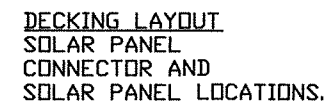

ITEM	QTY.	DESCRIPTION	LENGTH	X	WIDTH	TOTAL	U.M.
6	6	PLYWOOD, 48 x 96 x 1/4"	96	X	48	192.00	SF
7	1	PLYWOOD, 48 x 96 x 1/4"	96	X	10	6.67	SF
					TOTAL	198.67	SF

