

FORESTER^{TS}

BY FOREST RIVER



Forester TS gets you from the infield to the outer banks in style.

**Ultra-Light Weight
Maneuverability with
Exceptional Fuel Efficiency**



The ultra-light Forester TS is engineered for fuel efficiency with eco-friendly building materials. These lightweight, Poplar cabinets are certified to be sustainably sourced from European forests.



There's well-planned storage everywhere!



5.3 Cu. ft Eurostyle Refrigerator operates on 12V/110/LP

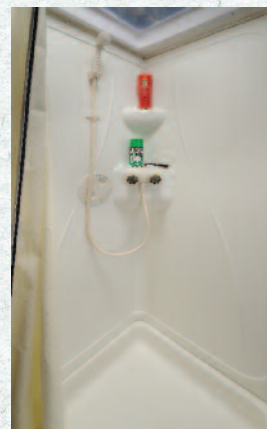
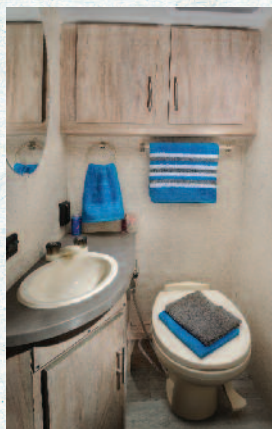



TV stows away when not in use. Forester TS offers a contemporary light weight design that's not light on storage and amenities!

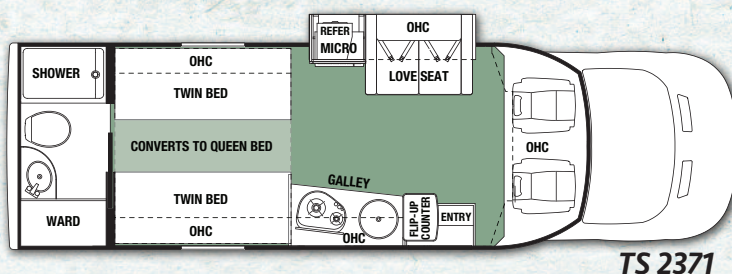

TS 2371

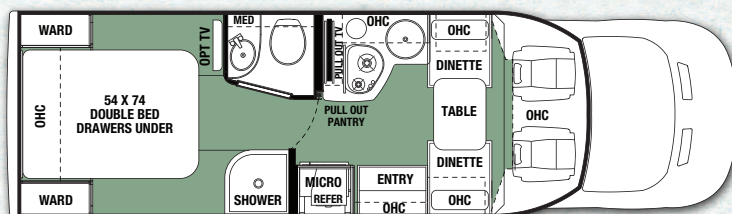

TS 2391

Forester TS	2371	2391
Wheelbase	178"	178"
GVWR	10,360	10,360
UVW	8,050	8,050
GCWR	13,500	13,500
CCC	2,310	2,310
Fuel Capacity (Gal.)	25	25
Hitch Rating (Lb.)	2,000	2,000
Length - Bumper to Bumper	25' - 6"	25' - 6"
Exterior Height with A/C	10' - 3"	10' - 3"
Exterior Width	87"	87"
Interior Width	84"	84"
Interior Height Front/Rear	78"	78"
Fresh/Grey/Black Water (Gal.)	35/29/29	35/29/29
L.P. Capacity (Gal.)	9.8	9.8
Awning Length	15'	15'
Water Heater (Gal.)	2.5	2.5
Exterior Storage (Cu. Ft.)	38	38
Seat Belts	4	4

GVWR (Gross Vehicle Weight Rating) - is the maximum permissible weight of the unit when fully loaded. It includes all weights, inclusive of all fluids, occupants, cargo, optional equipment and accessories. For safety and product performance do NOT exceed the GVWR.

GCWR (Gross Combined Weight Rating) - is the maximum permissible loaded weight of your motor home and any towed trailer or towed vehicle. Actual GCWR of this vehicle may be limited by the sum of the GVWR and the installed hitch receiver maximum capacity rating; see hitch rating label for detail.

GAWR (Gross Axle Weight Rating) - is the maximum permissible weight, including cargo, fluids, optional equipment and accessories that can be safely supported by each axle.

UVW (Unloaded Vehicle Weight) - is the typical weight of the unit as manufactured at the factory. It includes all weight at the unit's axle(s), including full fuel, all fluids and LP Gas. The UVW does not include cargo, fresh potable water, additional optional equipment or dealer installed accessories.

CCC (Cargo Carrying Capacity)** - is the amount of weight available for fresh potable water, cargo, passengers, additional optional equipment and accessories. CCC is equal to GVWR minus UVW. Available CCC should accommodate fresh potable water (8.3 lbs. per gallon). Before filling the fresh water tank, empty the black and gray tanks to provide for more cargo capacity.

*Estimated Average based on standard build optional equipment.
**Estimated Average based on standard build optional equipment.

Each Forest River RV is weighed at the manufacturing facility prior to shipping. A label identifying the unloaded vehicle weight of the actual unit and the cargo carrying capacity is applied to every Forest River RV prior to leaving our facilities. The load capacity of your unit is designated by weight, not by volume, so you cannot necessarily use all available space when loading your unit. Actual towing capacity is dependent upon your particular loading and towing circumstances, which includes the GVWR, GAWR and GCWR as well as adequate trailer brakes. Please refer to the Operator's Manual of your vehicle for further towing information.



This holding tank vent cap eliminates odors and gases from the holding tanks and exhausts them out the roof, without the use of costly chemicals.



Truma Combi™, the lightweight, forced-air furnace that combines heat and warm water in one appliance.



Light weight window and shade system



Pass through storage



Easy exterior trash access



A single lightweight lithium-ion battery has 10 times the lifespan of two traditional lead acid batteries. They charge faster, are 95% energy efficient, withstand corrosion, won't freeze, and has fewer maintenance requirements.

All information contained in this brochure is believed to be accurate at the time of publication. However, during the model year, it may be necessary to make revisions and Forest River, Inc., reserves the right to make all such changes without notice, including prices, colors, materials, equipment and specifications as well as the addition of new models and the discontinuance of models shown in this brochure. Therefore, please consult with your Forest River dealer and confirm the existence of any materials, design or specifications that are material to your purchase decision.

©2016 Forester - a Division of Forest River, Inc. - a Berkshire Hathaway Company 4/16

FORESTER^{TS}
BY FOREST RIVER

914 CR 1 • Elkhart, IN 46514 • 574.262.2212 • 800.445.2825
www.forestriverinc.com/forester

Your Local Forester Dealer



Learn More
Scan this barcode using a QR Reader on your smart phone to learn more about Forest River.



A Berkshire Hathaway company.