

**SHASTA**





# REVERE

Revere offers floorplans to suit every family's needs, a true 7-foot ceiling, 42-inch-deep super slides, and glazed, arched cathedral-style cabinet doors throughout. Choose from three custom-designed décor packages.



Kitchens include a 3-burner cooktop with high-output front burner and electronic ignition, large oven, oversized deep-well 50/50 sinks, carousel microwave and double-door refrigerator.



Bathrooms boast plentiful storage, an ABS tub/shower surround, marine toilet with foot flush, large sink, and a wooden medicine cabinet with mirror.



Every Revere offers a variety of storage opportunities, as in our full, convertible pantry. Just remove the top shelf, and the pantry converts to a spacious wardrobe.



Bedrooms offer an innerspring queen mattress, extra-large 3-door cabinet over the queen bed, cable TV hookup, full-length shirt wardrobes and under-bed storage with gas struts.

○ carpet    ● vinyl    ● comfort areas

# REVERE FLOORPLANS

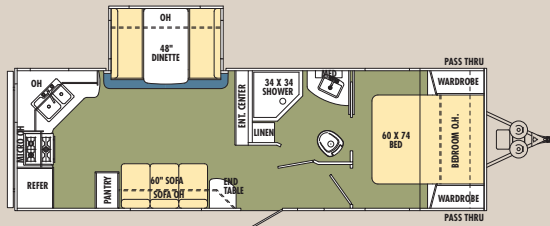

**25RKSS**

Total Weight: 6262  
CCC: 2794.2  
Box Length: 26'-6"  
Overall Length: 29'-6"

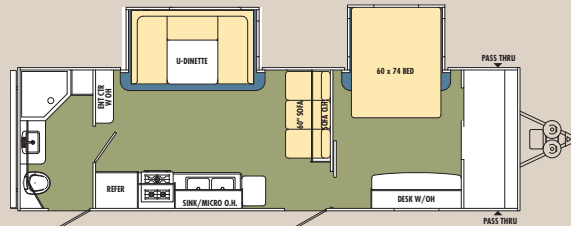

**26RBSS**

Total Weight: 7079  
CCC: 3419.2  
Box Length: 29'-0"  
Overall Length: 32'-0"

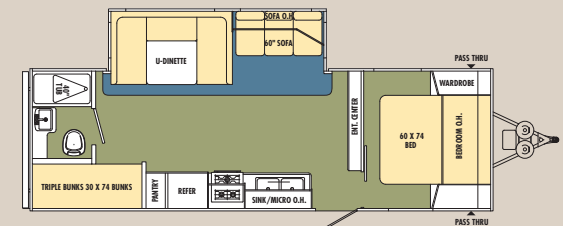

**26TBQB**

Total Weight: 6293  
CCC: 2896.2  
Box Length: 26'-2"  
Overall Length: 29'-2"

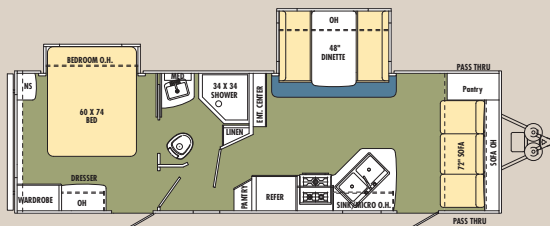

**27FLBS**

Total Weight: 6972  
CCC: 3634.2  
Box Length: 28'-0"  
Overall Length: 31'-0"

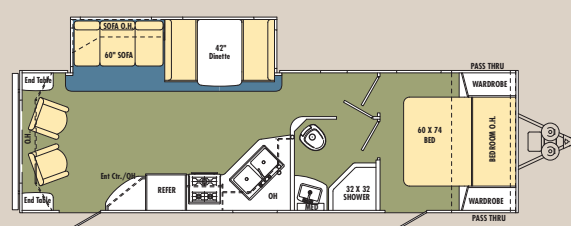

**27RLSS**

Total Weight: 6590  
CCC: 2704.2  
Box Length: 27'-11"  
Overall Length: 30'-0-11"

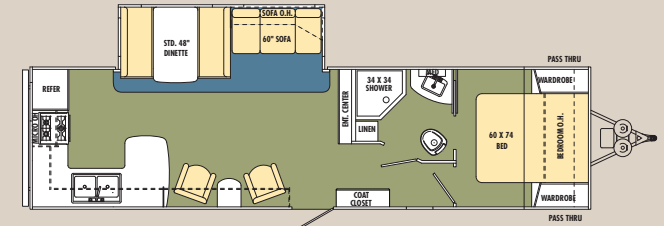

**29RKSS**

Total Weight: 7416  
CCC: 3039.2  
Box Length: 31'-10"  
Overall Length: 34'-10"

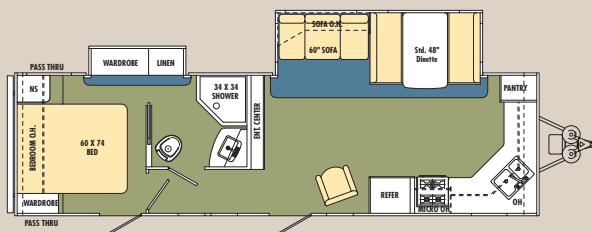

**30FKDS**

Total Weight: 7380  
CCC: 3266.2  
Box Length: 31'-1"  
Overall Length: 34'-1"

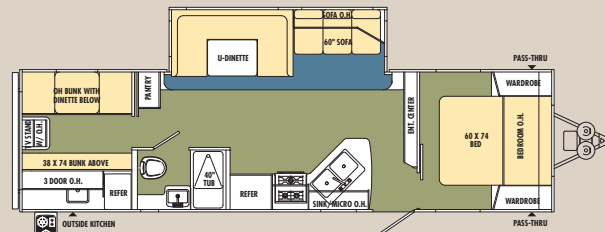

**30CKBH**

Total Weight: 7444  
CCC: 2967.2  
Box Length: 30'-2"  
Overall Length: 33'-2"

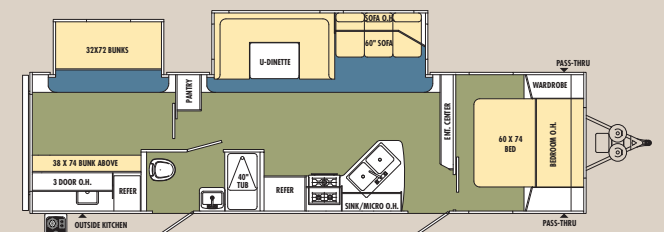

**32CKDS**

Total Weight: 8192  
CCC: 2504.2  
Box Length: 32'-6"  
Overall Length: 35'-6"



# REVERE LE



Overall, Revere LE's interiors include top of the line Beauflor® tile flooring, residential cabinets with mortise and tenon hardwood-framed doors and solid wood drawer fronts, in-floor ducted heat, and an auto-ignition furnace with wall thermostat. Easy-care decors make the seating areas, coordinating wall treatments and appointments really stand out.



Kitchens include attractive laminated countertops, a large, acrylic deep-well divided sink with high-rise faucet, 3-burner cooktop with high-output front burner and electronic ignition, range hood with light and exhaust fan, a large oven, a carousel microwave, and a generous double-door refrigerator, as well as a comfortable dinette.



LE offers accessible, functional storage throughout. Spacious overhead cabinets store everything necessary to complete your vacation meal plan. All drawers feature solid wood fronts and smooth-sliding, full-extension ball bearing drawer guides.



Bedrooms offer an innerspring queen mattress with padded headboard, an extra-large 3-door cabinet over the queen bed, overhead reading lights, cable TV hookup, full-length his-and-her shirt wardrobes with overhead storage shelf, and under-bed/pass-through storage with gas struts.



Complete baths feature a spacious vanity with large sink, a wooden medicine cabinet with mirror, and a foot-flush marine toilet. Other features include a curved shower curtain track, power ceiling vent and easy-clean Beauflor® tile flooring.

○ carpet    ● vinyl    ● comfort areas

# REVERE LE FLOORPLANS

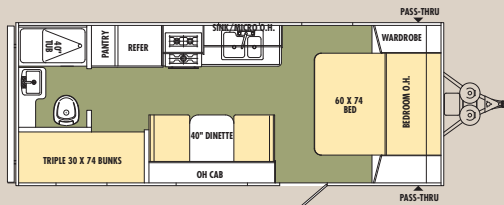

**21TB**

Total Weight: 4395  
CCC: 2509.2  
Box Length: 20'-11½"  
Overall Length: 23'-11½"

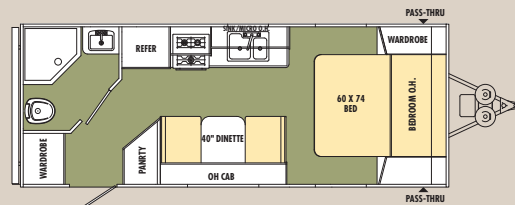

**21RB**

Total Weight: 4500  
CCC: 2411.2  
Box Length: 21'-6"  
Overall Length: 24'-6"

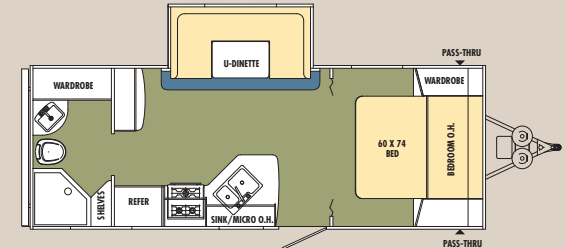

**21FBS**

Total Weight: 5370  
CCC: 1806.2  
Box Length: 22'-6"  
Overall Length: 25'-6"

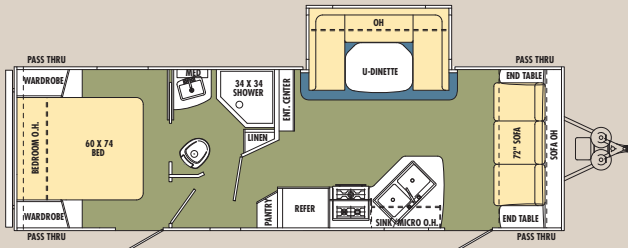

**26FLS**

Total Weight: 6374  
CCC: 2965.2  
Box Length: 27'-6"  
Overall Length: 30'-6"

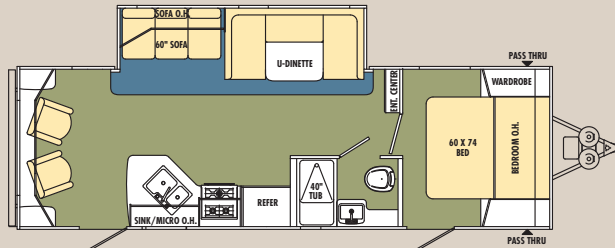

**26RLS**

Total Weight: 6435  
CCC: 2726.2  
Box Length: 26'-9"  
Overall Length: 29'-9"

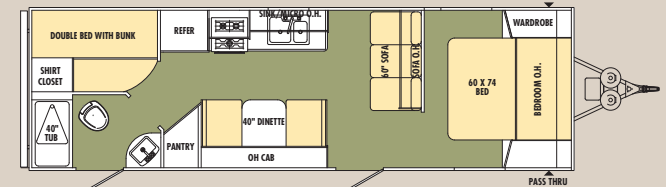

**27BH**

Total Weight: 5777  
CCC: 3212.2  
Box Length: 27'-9"  
Overall Length: 30'-9"



LE's pass-through storage compartment is connected with the bedroom's under-bed storage area, making for one super-sized cargo space that's easy to get to from inside and out.

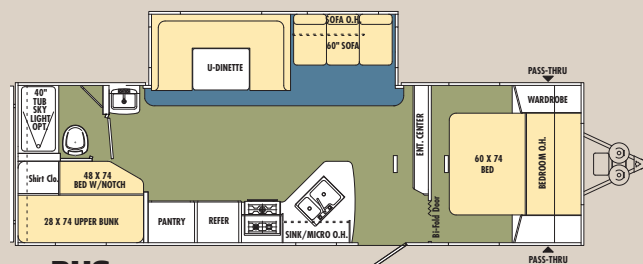

**27BHS**

Total Weight: 6191  
CCC: 2911.2  
Box Length: 27'-9"  
Overall Length: 30'-9"

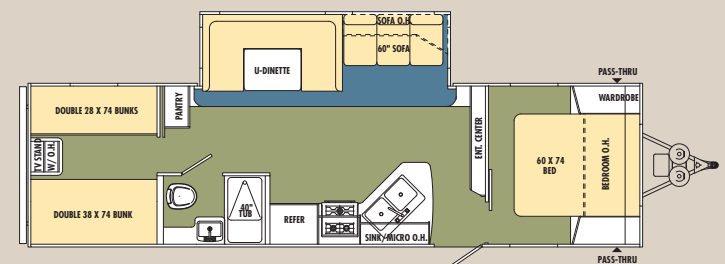

**30QBS**

Total Weight: 6747  
CCC: 3677.2  
Box Length: 28'-7"  
Overall Length: 31'-7"

# SPECIFICATIONS

	Revere	LE
<b>Construction Features</b>		
.024 Aluminum Exterior Skin	X	X
.030 Radius Skirt Metal	X	
R-7 Fiberglass Insulation in Sidewall, Roof & Floor	X	X
5/8" Tongue & Groove Plywood Floor Decking	X	X
Roof Rafters: Wood Tapered 4 1/2" Trusses	X	X
1/2" Plywood Dinette, Bed & Bunk Platforms	X	X
Aerodynamic Radius Front Profile	X	X
2" Wall Studs on 16" Centers	X	X
42" Deep Electric-Powered Slide Rooms	X	X
Fiberglass Slide Room End Walls	X	X
Prep for Rear Ladder	X	X
Fully Walkable Roof w/3/8" Decking	X	X
1-Piece Seamless EPDM Rubber Roof w/12-Year Warranty	X	X
8' Exterior Width	X	X
84" (7') Interior Ceiling Height	X	X
73" (6' 1") Slide Room Ceiling Height	X	X
2" x 3" Longitudinal Floor Joists	X	X
Cambered Structural Steel I-Beam Frame	X	X
Integrated A-Frame	X	X
<b>Heating / Air Conditioning / Power / Water Equipment</b>		
Hook Up for City Water	X	X
Systems Monitor Panel	X	X

	Revere	LE
12V Demand Water Pump	X	X
Dual Ducted 13.5 BTU Roof A/C	X	
13,500 BTU Roof A/C		X
Louvered Directional Ceiling Vents & Wall Thermostat	X	X
Quick Cool A/C Grill	X	X
12V Electrical System w/Deluxe 110V 45-Amp Power Converter	X	X
6-Gal. Gas/Electric DSI Hot Water Heater	X	
6-Gal. Gas DSI Hot Water Heater		X
30-Amp Detachable Power Cord	X	
30-Amp Power Cord		X
1 10V GFCI Protected Exterior Receptacle	X	X
Auto-Ignition Furnace w/Wall Thermostat (30-35K BTU)	X	X
In-Floor Ducted Heat	X	X
Roto Cast Holding Tanks	X	X
Water System Winterization Kit	X	X
Water Heater Bypass	X	X
<b>Bathroom Equipment</b>		
Black Tank Flush	X	X
Shower Curtain w/Curved Shower Track for Tubs	X	X
ABS Tub/Shower Surround	X	
Glass Door for Neo-Angle Showers (where available)	X	X
Bathroom Power Vent	X	X
Bathroom Door Casing	X	X
Marine Toilet w/Foot Flush	X	X
Toilet Paper Holder	X	X

	Revere	LE
Large Sink in Bathroom	X	X
Wooden Medicine Cabinet w/Mirror	X	X
Beauflor® Tile Flooring	X	X
<b>Standard Kitchen Equipment</b>		
Microwave Oven w/Carousel	X	X
High-Rise Faucet	X	X
Black Refrigerator Panels	X	X
Acrylic Residential-Style Deep Well Sink (50/50) w/Sink Covers	X	
Acrylic Deep Well Sink		X
3-Burner Cooktop w/HO Front Burner & Piezo Igniter	X	X
Range Hood w/Light & Exhaust Fan	X	X
Ball Bearing Drawer Guides	X	X
Built-In Spice Rack (select models)	X	X
Large Oven	X	X
Skylight w/Pleated Shade Covering	X	
Trashcan Cabinet in Kitchen	X	X
Double-Door Refrigerator	X	X
Beauflor® Tile Flooring	X	X
<b>Standard Bedroom Equipment</b>		
Bedroom Roof Vent	X	
Full-Length Shirt Wardrobes in Bedroom	X	X
Extra-Large OH Cabinet over Queen Bed w/3 Doors	X	X
Padded Headboard	X	
Innerspring Mattress	X	X
Quilted Upgraded Foam Mattresses for Bunk Beds	X	X

	Revere	LE
Residential Queen Bedspread (where applicable)	X	X
Carpet (select models)	X	
Cable TV Hook-Up	X	X
Overhead Courtesy Shelf w/110V Outlet	X	X
Under-Bed Storage w/Gas Struts	X	X
<b>Standard Exterior Equipment</b>		
Heated and Enclosed Underbelly	X	
Extra-Large Folding Grab Handle	X	
Entry Door Grab Handle		X
Front Diamond Plate Rock Guard	X	X
15" Radial Tires w/White Steel Rims (slide models only)	X	X
14" Tires w/White Steel Rims (non-slide models only)		X
Monogrammed Fender Skirt	X	X
Chrome Hub Caps	X	
Front Hitch Light	X	X
(2) Outside Speakers on Door Side	X	
Deluxe Patio Awning	X	X
ABS Propane Gas Bottle Cover w/EZ Bottle Access	X	
Bumper w/Drain Hose Carrier & End Caps	X	X
Lighted Pass-Thru Exterior Storage	X	
Pass-Thru Exterior Storage		X
Oversized Inside/Outside Accessible Pass-Thru Storage	X	X
2" Thick Insulated, Radius-Cornered Baggage Doors	X	X



	Revere	LE
Straight Axles w/Electric Brakes	X	X
E-Z Lube Axles	X	X
Painted Lower Body Side Metal & Matching Door Striping	X	
Color-Coordinated Metal Color Band		X
Radius Painted Lower-Bodyside Skirt Metal	X	
2-Way Patio Light/Scare Light w/Inside Switch	X	
Amber Patio Light w/Inside Switch		X
Radius-Cornered Fiberglass Entrance Door w/Screen Door	X	X
Newly Designed Entry Door Latch	X	
Molded Rain Guttering w/X-Lg Drip Spouts	X	X
Radius Retractable Entrance Step (Non-Slides: (2) Steps, Slides: (3) Steps)	X	X
Black-Framed Radius Tinted (G55) Safety Glass Windows	X	X
LP Connection w/Quick Connect	X	
Exterior Shower w/Hot & Cold Water	X	

#### Standard Interior Equipment

Sliding Pocket-Style Doors (select models)	X	
Accordion-Style Sliding Privacy Doors (select models)		X
Pocket-Bore Screwed Cabinets	X	X
Glazed Arched Cathedral-Style Cabinet Doors Throughout	X	
Mortise & Tenon Hardwood-Framed Cabinet Doors		X
Wrapped Slide Fascia	X	X

	Revere	LE
OH Cabinet w/Etched Glass Doors over Sofa in Super-Slides	X	
OH Cabinet over Sofa in Super-Slides		X
OH Cabinet over Sofa in Sofa-Slides	X	X
Solid Wood Drawer Fronts	X	X
Radius Dinette Booth Back Tops w/2 Storage Doors (where available)	X	
Radius Dinette Booth Back Tops (where available)		X
Large 40" x 76" Dinettes in Non-Slide Models	X	X
X-Lg 45" x 76" Dinettes in Super-Slide Models (where applicable)	X	X
Family Size U-Shaped Dinette (where applicable)	X	X
Residential Lighting in Slide Out above Dinette	X	X
X-Lg Picture Window at Dinette	X	
Picture Window at Dinette		X
Residential Convertible Sofa	X	X
Full-Way Entertainment Center configured for 42" TV (where applicable)	X	
TV Cabinet configured for 42" TV (where applicable)		X
AM/FM CD/DVD w/Surround Sound 4-Speaker System	X	X
Cable TV Hook-Up w/RG6 Coax Cabling	X	X
Satellite Prep	X	
Carpet w/Padding (where available)	X	
Beaflor® Tile Flooring	X	X
Roof-Mounted Antenna for Radio	X	X

	Revere	LE
Swivel Rocker(s) (1 or 2 on select models)	X	X
Crank-Up TV Antenna w/Signal Booster	X	X
Fabric-Covered Box Valances w/Lambrequin Legs	X	
Fabric-Covered Box Valances		X
Mini-Blinds Throughout	X	X
Wallpaper Border	X	X

#### Capacity

Fresh Water 50-gal on Slide Models	X	X
Fresh Water 37-gal on Non-Slide Models		X
Grey Water 37-gal	X	X
Black Water 37-gal	X	X
(2) 30# LP Gas Bottles w/Auto Changeover	X	
(2) 20# LP Gas Bottles w/Auto Changeover		X

#### Standard Safety Equipment

Propane Alarm	X	X
Break-Away Switch	X	X
Dead-Bolt Lock on Entrance Door	X	X
Dual Hitch Safety Chains	X	X
Smoke Alarm	X	X
Egress Window(s)	X	X
Fire Extinguisher	X	X
Black-Framed Radius Tinted (G55) Safety Glass Windows	X	X
Carbon Monoxide Alarm	X	X

## OPTIONAL EQUIPMENT

	Revere	LE
<b>Exterior Options</b>		
Spare Tire & Carrier	X	X
Aluminum Rims	X	
Stabilizer Jacks	X	X
Dual 30# LP Bottles w/Cover		X
Outside Shower		X
(2) Exterior Speakers		X
Rear Ladder	X	X
Pull-Out Rear Bumper Extension/Bike Rack		X
Toylock		X
Electric Awning	X	
Pac-n-Play Door	X	X
Sliding Patio Door	X	
RVQ Grill	X	

#### Interior Upgrades

Residential Hide-a-Bed Sleeper Sofa	X	
26" LED Flat Screen TV	X	X
8-cu-ft Double-Door Refrigerator in Kitchen	X	
Rear Dinette IPO Lower Bunk	X	X
Night Shades in Living Room	X	
Free-Standing Dinette	X	
(2) Sink Covers		X
Range Cover	X	X
Skylight in Shower	X	X
ABS Tub/Shower Surround		X

#### Heating & Cooling Upgrades

15,000 BTU A/C IPO 13,500 BTU A/C	X	X
Ducted A/C		X
Dual Pane Windows	X	X
QAI Canadian Compliance	X	X

#### PACKAGES

##### Premium Camping Package

RV Lock Keyless Entry System	X
Pull-Out Rear Bumper Extension/Bike Rack	X
Toy Lock	X
Premium Evergreen Pillowtop Sleep System	X

##### Luxury Camping Package

Upgraded Ultra-Soft Touch Sofa	X
Upgraded Ultra-Soft Touch Chairs	X
Residential Pull-Out Sprayer Faucet	X
Upgraded Residential Window Treatments	X

# THE SHASTA STORY

## A PROUD HERITAGE

In 1941, when Californian Robert Gray built the first Shasta "house trailer" to be used as mobile military housing, he had no idea his homes on wheels would play a major role in establishing a billion-dollar industry. Or, that the little trailers would spark wanderlust in Americans that would carry them across the miles and into the next century. Shasta was, and remains, an important player in the ultimate American Dream; the freedom and desire to roam, explore and enjoy well-earned leisure time with the people we love.



Today, 70 years and three generations of Shasta owners later, Americans have the desire to travel like never before. Motivated by the rediscovery of our families and renewal of ourselves, we still respond to the call of the road.

As the industry's longest producer of recreational vehicles, we've earned our success in the best possible way – through experience ... more experience than

any other RV company in the world. Shasta's respected name prevails in today's fast-moving RV industry because of that experience, combined with a strong, service-oriented dealer network, a loyal, repeat customer base, and our outstanding association with our parent company, Forest River. Shasta is proud of its longevity, and we pledge to continue to listen and to improve our commitment to satisfying America's wanderlust, and to persist in creating generations of memories to come!



A Division of Forest River, Inc.®

Shasta Recreational Vehicles  
105 CR 14  
Middlebury, IN 46540  
(574) 825-7178  
[www.shastarving.com](http://www.shastarving.com)

All illustrations and specifications contained in this brochure are based on the latest product information at time of publication. Shasta Recreational Vehicles reserves the right to make changes in prices, colors, materials, equipment and specifications, and to discontinue models at any time without notice. Some equipment shown separately, or on products illustrated in this brochure, may be optional at extra cost. Check with your Shasta dealer for more information if you have specific questions.

© 2011 Shasta Recreational Vehicles, a Division of Forest River, Inc., a Berkshire Hathaway company



### PRE-DELIVERY INSPECTION FACILITY

20,000 square feet of quality assurance. The bare essentials for a premium product. This state-of-the-art facility gives immediate daily feedback to production for quality assurance in every unit built.



**Forest River, Inc. encourages our customers to purchase their Forest River products from a local dealership whenever possible for the following reasons:**

- 1) Forest River, Inc. dealers are independently owned and operated businesses so priority service and scheduling is at their discretion and is often provided to customers that purchased their unit at that dealership.
- 2) Purchasing locally allows customers to establish meaningful relationships with a dealer, enhancing the RV experience through assistance with product questions, user tips or RV regulations for your state or country, and much more!
- 3) Canadian customers must meet requirements to bring an RV purchased out of the country to their home. These requirements may involve additional inspections and certifications, taxes and fees. Your local Canadian Dealer is a professional at meeting these requirements.
- 4) Scheduling timely warranty repairs and adjustments through a local dealership provides far greater flexibility and convenience to you, the customer!

It is the goal of Forest River, Inc. that all of our RV owners fully enjoy the RV experience and that customer satisfaction meets or exceeds their expectations!



#### Learn More

Scan this barcode using a QR Reader on your smart phone to learn more about Forest River.



A Berkshire Hathaway company.