



# INSTALLATION MANUAL

RM2351 RM2554 DM2862  
RM2354 DM2652 DM3862  
RM2451 DM2662 NDM1062  
RM2454 DM2663 NDR1292  
RM2551 DM2852

REFRIGERATOR FOR LP-GAS  
& ELECTRIC OPERATION

## FOR YOUR SAFETY

If you smell gas:

1. Open windows.
2. Don't touch electrical switches.
3. Extinguish any open flame.
4. Immediately call your gas supplier.

## POUR VOTRE SÉCURITÉ

Si vous sentez une odeur de gaz:

1. Ouvrez les fenêtres.
2. Ne touchez à aucun interrupteur.
3. Éteignez toute flamme nue.
4. Avertissez immédiatement votre fournisseur de gaz.

## FOR YOUR SAFETY

Do not store or use gasoline or other flammable vapors and liquids in the vicinity of this or any other appliance.

## POUR VOTRE SÉCURITÉ

Ne pas entreposer ni utiliser de l'essence ni d'autres vapeurs ou liquides inflammables à proximité de cet appareil ou de tout autre appareil.

## WARNING

Improper installation, adjustment, alteration, service or maintenance can cause injury or property damage. Refer to this manual. For assistance or additional information consult a qualified installer, service agency or the gas supplier.

## AVERTISSEMENT

Une installation, un réglage, une modification, une réparation ou un entretien non conforme aux normes peut entraîner des blessures ou des dommages matériels. Lisez attentivement le mode d'emploi fourni avec l'appareil. Pour obtenir de l'aide ou des renseignements supplémentaires, consultez un installateur ou un service d'entretien qualifié ou le fournisseur de gaz.



### USA

Service Office  
Dometic Corporation  
2320 Industrial Pkwy.  
Elkhart, IN 46516  
Phone: 574-294-2511

### Corporate Office

2320 Industrial Parkway Elkhart, IN 46515

### For Service Center Assistance

Call: 800-544-4881

### CANADA

Dometic Corporation  
48 Zatonski, Unit 3  
Brantford, ON N3T 5L8  
CANADA  
Phone: 519-720-9578



# INTRODUCTION

This manual describes the installation procedure of RM2351, RM2354, RM2451, RM2454, RM2551, RM2554, DM2652, DM2662, DM2663, DM2852, DM2862, DM3862, NDM1062 and NDR1292.

The installation is to be performed by qualified personnel only and must conform to all relevant local authorities. Please read this manual thoroughly before installing the refrigerator. To ensure safe and efficient operation, the refrigerator must be installed as described in this manual. Be aware of possible safety hazards when seeing alert symbols on the refrigerator as well as in this manual.

For information about maintenance and operating instructions, refer to the USER MANUAL.

## CONTENTS

<b>CERTIFICATION AND CODE REQUIREMENTS</b> .....	<b>4</b>	<b>MOUNTING INSTRUCTIONS</b> .....	<b>11</b>
<b>VENTILATION REQUIREMENTS</b> .....	<b>4</b>	Reversing the door swing .....	11
General information .....	4	Mounting the door panel(s) .....	11
Ventilation heights .....	5	<b>REFRIGERATOR REMOVAL</b> .....	<b>12</b>
Clearances .....	5	<b>APPENDIX A - REARVIEW EQUIPMENT</b> .....	<b>13</b>
Overall and recess dimensions .....	6	<b>APPENDIX B - WIRING DIAGRAMS</b> .....	<b>16</b>
<b>INSTALLATION INSTRUCTIONS</b> .....	<b>7</b>		
Installing the refrigerator .....	7		
Securing the refrigerator .....	7		
Connections .....	9		

## SYMBOLS

The following symbols are used throughout the manual:



Indicates a potentially hazardous situation, which, if not avoided, could result in death or serious injury.



Indicates a potentially hazardous situation, which, if not avoided, may result in minor or moderate injury.



Used without the safety alert symbol indicates, a potentially hazardous situation which, if not avoided may result in property damage.



Information



Step-by-step instructions

# CERTIFICATION AND CODE REQUIREMENTS

This appliance is certified under the latest edition of ANSI Z21.19•CSA 1.4 Refrigerators using gas fuel. The installation must conform with local codes, or in absence of local codes, the following standards as applicable.

## In the U.S. the installation must conform with:

- National Fuel Gas Code, ANSI Z223.1/NFPA 54 (latest edition).
- Recreational Vehicles Code, ANSI A119.2 (latest edition).
- Manufactured Home Construction and Safety Standard, Title 24 CFR, Part 3280.

If an external electrical source is utilized, the refrigerator, when installed, must be electrically grounded in accordance with local codes or, in the absence of local codes, the National Electrical Code, ANSI/NFPA 70 - (latest edition).

## In CANADA, the installation must conform with:

- Natural Gas and Propane Installation Code, CSA B149.1
- CSA Z240 RV Series, Recreational Vehicles.
- Current CSA Z240.4, Gas-equipped Recreational Vehicles and Mobile Housing.

If an external electrical source is utilized, the refrigerator, when installed, must be electrically grounded in accordance with local codes or, in the absence of local codes, the Canadian Electrical Code, CSA C22.1, Parts I and II - (latest edition).



## VENTILATION REQUIREMENTS

### GENERAL INFORMATION

Ventilation is one of the requirements for proper cooling unit operation. The installation should be made in such a manner as to separate the combustion system from the living space of the mobile home or recreational vehicle. Openings for air supply or for venting of combustion products should have a minimum dimension of not less than 1/4 inch.

Proper installation requires one lower fresh air intake and one upper exhaust vent. Certified installations require one roof vent and one lower side vent. The ventilation kits shown in this manual have been certified for use with the different models as displayed in the “Certified Vent System Kits” table.

The ventilation kits must be installed and used without modification! An opening toward the outside at floor level in the refrigerator compartment has to be provided for ventilation of heavier-than-air fuel gases. The lower vent of the recommended kits is provided with proper size openings. The flow of combustion and ventilating air must not be obstructed.

### CAUTION

**It is of especially importance that the air-flow around the burner housing, the boiler insulation and the flow of combustion gases must not be obstructed. Items placed in the vicinity of the refrigerator compartment accordingly must be secured away from the refrigerator tubing and flue.**

The lower side vent is fitted with a panel, which provides an adequate access opening for ready serviceability of the burner and control manifold of the refrigerator. This should be centered on the back of the refrigerator.

Certified Vent System Kits			
Model	Kit No.	Components	Part no.
RM2351 RM2354	2A	Roof Base Roof Cover Lower Side Vent Lower Side Vent	3103633.XXX* or 3310893.XXX* 3103634.XXX* or 3310894.XXX* 3109350.XXX* RM183
	3A	Upper Side Vent Lower Side Vent  Power Vent Ass'y Upper Side Vent Upper Side Vent Lower Side Vent Lower Side Vent	RM123A RM183  3108705.751** RM123A 3109492.003 RM183 3109492.003
RM2451 RM2454 RM2551 RM2554	3A	Roof Base Roof Cover Lower Side Vent	3103633.XXX* or 3310893.XXX* 3103634.XXX* or 3310894.XXX* 3109350.XXX*
DM2652 DM2662 DM2663 DM2852 DM2862 DM3862 NDM1062	4A	Roof Base Roof Cover Lower Side Vent	3103633.XXX* or 3310893.XXX* 3103634.XXX* or 3310894.XXX* 3109350.XXX*
NDR1292	5A	Roof Base Roof Cover Lower Side Vent Power Vent Ass'y	3103633.XXX* or 3310893.XXX* 3103634.XXX* or 3310894.XXX* 3103649.XXX* 3108705.744**

\* Replace “XXX” with the color code numbers. For color codes, contact your supplier.

\*\* Alternate instructions forwarded with the Ventilator Kit.

For further information, contact your dealer or distributor.

# VENTILATION REQUIREMENTS

## VENTILATION HEIGHTS

It is essential that all maximum or minimum dimensions are strictly maintained, as the performance of the refrigerator is dependent on adequate flow of air over the rear of the refrigerator.

Minimum ventilation heights				
	Roof vent and lower side vent <b>A</b>		Upper and lower side vent <b>B</b>	
	inches	mm	inches	mm
RM2351 RM2354	31	787	34	864
RM2451 RM2454	37-3/4	960		
RM2551 RM2554	44-1/2	1130		
DM2652 DM2662 DM2663	57-3/4	1465		
DM2852 DM2862 DM3862 NDM1062	63-3/4	1620		
NDR1292	65	1651		

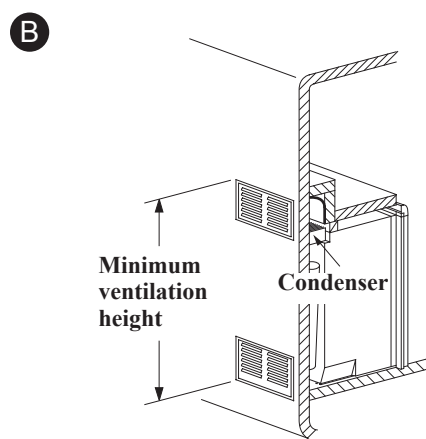
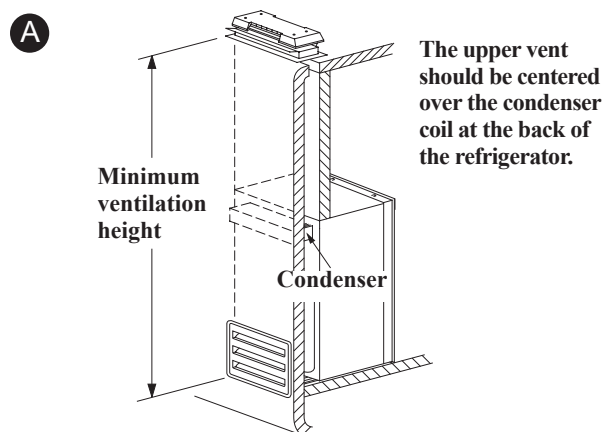

## CLEARANCES

Minimum clearances (in inches) to combustible materials:

Top ( <b>G</b> )	0
Side ( <b>K</b> )	0
Bottom ( <b>L</b> )	0
Rear ( <b>M</b> <sup>1</sup> )	0 / 1 (RM2351 & RM2354)

<sup>1</sup> M: The distance between the rearmost part of the refrigerator and the wall behind it.

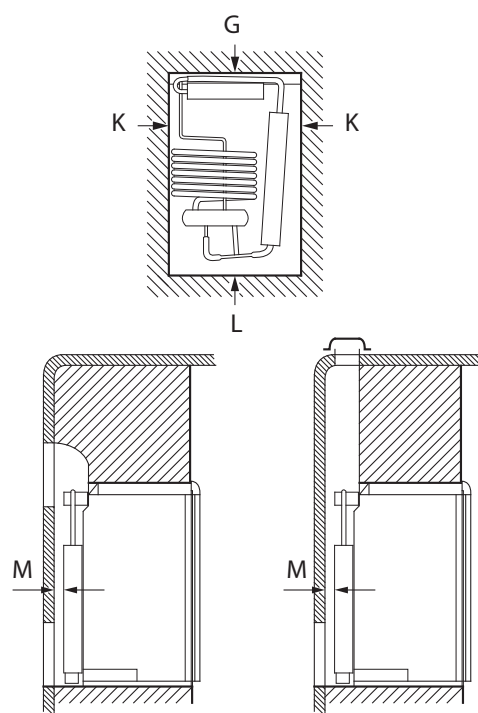

General view. Features may vary according to model.

# VENTILATION REQUIREMENTS

## OVERALL AND RECESS DIMENSIONS

<div>Dimensions</div> <div>Model</div>		Overall			Recess		
		Height A	Width B	Depth C	Height H	Width W	Depth D
RM2351 RM2354	inches	30-5/32	21-7/8	22-22/32	29-3/4	20-1/2	21-3/8
	mm	766	556	577	756	521	542
RM2451 RM2454	inches	37-3/8	24-7/8	24-11/16	39-9/16	23-11/16	24
	mm	948	632	627	928	602	610
RM2551 RM2554	inches	43-1/2	24-7/8	24-11/16	42-5/8	23-11/16	24
	mm	1104	632	627	1083	602	610
DM2652 DM2662 DM2663	inches	54-21/32	24-7/8	26-1/32	53-3/4	23-11/16	24
	mm	1388	632	661	1365	602	610
DM2852 DM2862 DM3862	inches	60-51/64	24-7/8	26-1/32	59-15/16	23-11/16	24
	mm	1544	632	661	1522	602	610
NDM1062	inches	60-54/64	24-7/8	26-5/8	59-15/16	23-11/16	24*
	mm	1544	632	676	1522	602	610*
NDR1292	inches	59-31/32	33-11/16	26-21/32	59-1/16	32-3/4	24*
	mm	1523	855	677	1500	832	610*

\* Add 1" (25 mm) depth for units with one or two optional ventilator fans.

Side view

View from above

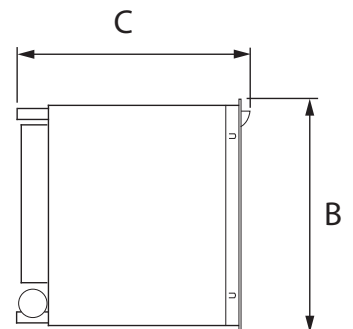
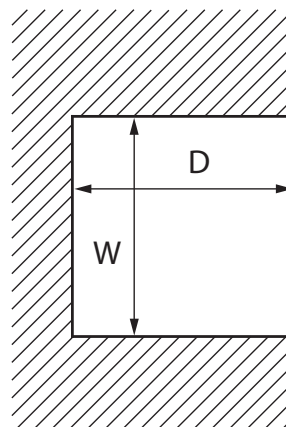
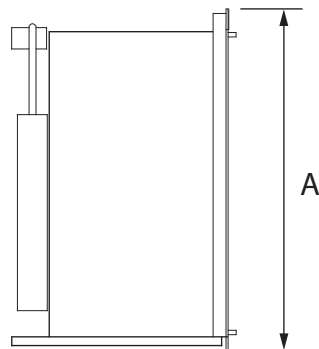
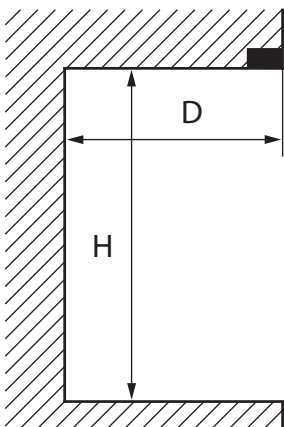

General view. Features may vary according to model.

# INSTALLATION INSTRUCTIONS

## INSTALLING THE REFRIGERATOR



Be careful when installing the refrigerator models **NDM1062 & NDR1292**. These are equipped with the latest vacuum insulated panel technology. The insulating panels are located on the top, back, bottom, sides and doors. If the surface is punctured, loss of insulation will occur, resulting in poor refrigerator performance.

For a proper installation, follow these instructions:

- Make sure the floor is solid and level.
- The refrigerator must be level and installed in a substantial enclosure.
- Do not install the appliance directly on carpeting. Carpeting must be removed or protected by a metal or wood panel beneath the appliance, which extends at least full width and depth of the appliance.
- **RM2451, RM2454, RM2551, RM2554, DM2652, DM2662, DM2663, DM2852, DM2862, DM3862, NDM1062 & NDR1292**

A **wood strip** must be in place across the upper opening of the enclosure. The top frame of the refrigerator will be anchored to the wood strip with screws.

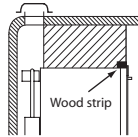

- When installing the refrigerator in the enclosure, all areas within the recess have to be sealed. Verify that there is a complete seal between the front frame of the refrigerator and the top, sides and bottom of the enclosure. A length of sealing strip is applied to the rear surface of the front frame for this purpose. The sealing strip should provide a complete isolation of the appliance's combustion system from the vehicle interior.

**RM2351 and RM2354:** Apply a sealing strip to the foremost floor of the enclosure.

**Be careful not to damage the sealing strip when the refrigerator is put in place!**

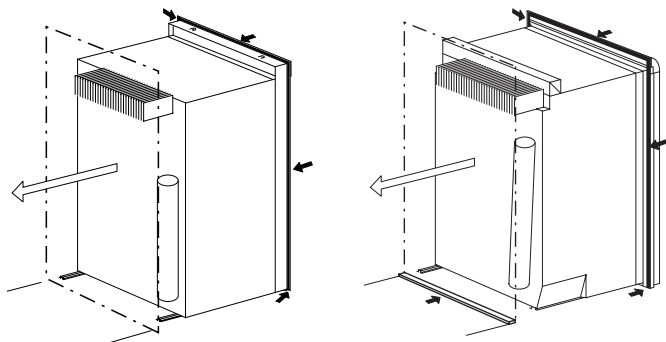

**RM2451, RM2454, RM2551, RM2554, DM2652, DM2662, DM2663, DM2852, DM2862, DM3862, NDM1062 & NDR1292**

**RM2351 & RM2354**

## SECURING THE REFRIGERATOR

It is important to follow the sequence in securing refrigerator in enclosure since failure in doing so can cause leakage between the frame and cabinet. Any space between the counter, storage area or ceiling and top of the refrigerator greater than 1 1/2 inches should be blocked. The heat produced at the rear of the refrigerator will become trapped in this space, making the top of the refrigerator hot and reduce the efficiency of the refrigerator.

After the refrigerator is put in place (ensuring a combustion seal at the front frame), the refrigerator is to be secured in the enclosure with screws (not included).

### RM2351 & RM2354

Install the five screws in the following order:



1. Four screws installed through the front frame. (To cover the screw heads, use the plugs in the parts bag.)
2. One screw installed in the rear base.

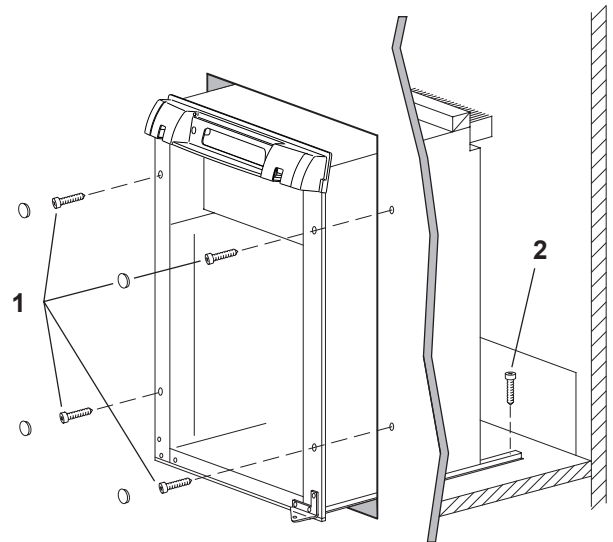

# INSTALLATION INSTRUCTIONS

RM2451, RM2454, RM2551, RM2554, DM2652, DM2662, DM2663, DM2852, DM2862, DM3862 & NDM1062

Install the screws in the following order:

## 1. Two screws installed through the front base. (Installation of the lower front strip.)

The refrigerator is provided with a lower front strip (shipped as a loose part). Attach the front strip after the refrigerator is set into the cutout opening.

- a) Install the lower front strip by sliding it under the bottom hinge plate. The hinge plate can be on the right or left side depending on the door swing. Once the lower front strip is slipped under the hinge, the part is possible to swing into place.

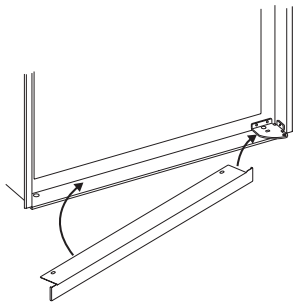

- b) Secure the refrigerator and the lower front strip with two screws: One screw through the hinge and on the opposite side and then, one screw through the lower front strip.

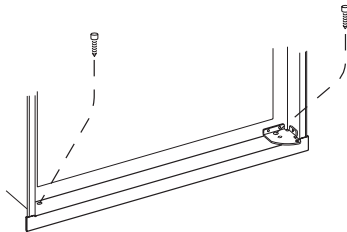

## 2. Two screws installed in the top frame.

- a) Open the door. Gently push the tabs out of the hole in the hinge with a flat blade screwdriver (both sides).
- b) Carefully tilt the top decoration panel and lift to remove from top frame. Be careful not to damage the circuit board and wires.
- c) Install the two screws in the top frame, the holes are accessible from underneath.
- d) Seal the opening for the screws with aluminum tape.
- e) Replace the top decoration panel. Be careful not to pinch the wires behind the panel. Make sure the tabs snap back into the holes in the hinge plate.

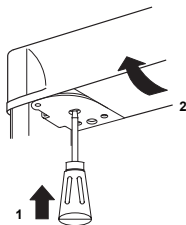

## 3. One screw installed in the rear base.

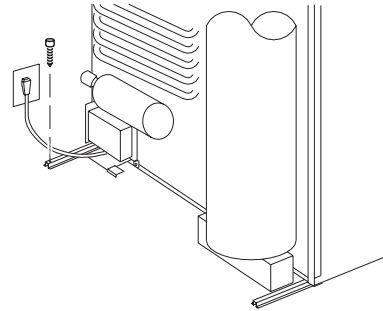

## NDR1292

Install the screws in the following order:

## 1. Two screws installed through the front base. (Installation of the lower front strip.)

The refrigerator is provided with a lower front strip (shipped as a loose part). Attach the front strip after the refrigerator is set into the cutout opening.

- a) Install the lower front strip by sliding it under the bottom hinge plate.

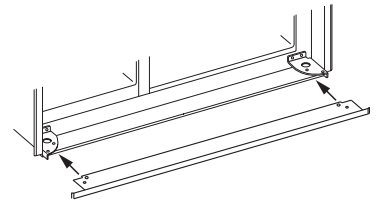

- b) Secure the refrigerator and the lower front strip with two screws: One screw through each hinge.

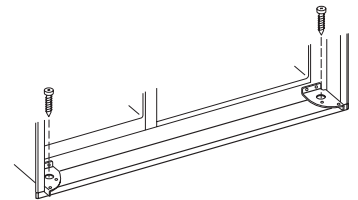

## 2. Screws installed in the top frame.

- a) Open the doors and remove the four screws that secure the top decoration panel to the top frame. Two screws are accessible from underneath and two are located on each side of the lock retainer securing the decoration panel to the front frame. Save screws for reinstallation of the top decoration panel.
- b) See step 2, b-e in the previous instruction.

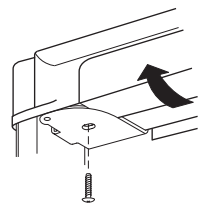

## 3. Two screws installed in the rear base.

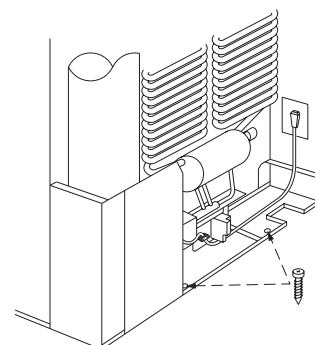



# INSTALLATION INSTRUCTIONS

## DRAIN WATER HOSE

Drill a hole through flooring. Seal around the hose that goes through the drilled hole and ensure that it does not kink when run through the floor. Check to make sure that the supplied hose is long enough in order for the water to drain outside of the vehicle. If not, the installer will have to supply the extra length of hose.

RM2351 & RM2354

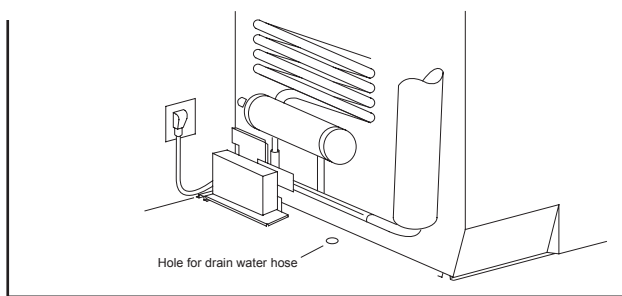

RM2451, RM2454, RM2551, RM2554, DM2652, DM2662, DM2663, DM2852, DM2862, DM3862 & NDM1062

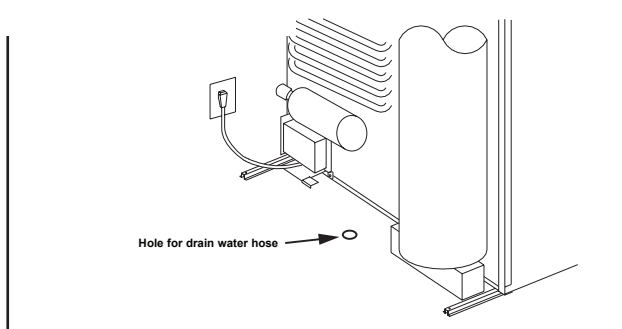

NDR1292

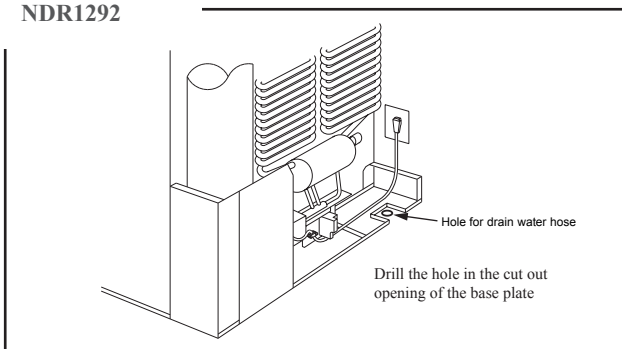

## CONNECTIONS

### Gas connection

Hook up to the gas supply line is accomplished at the manual gas valve, which is furnished with a 3/8" SAE (UNF 5/8" -18) male flare connection. All completed connections should be examined for leaks using a solution of liquid detergent and water.

### ⚠ WARNING

**EXPLOSION HAZARD. Never use an open flame to check for gas leaks. Failure to heed this warning could cause an explosion resulting in death or severe personal injury.**

The gas supply system must incorporate a pressure regulator to maintain a supply pressure of not more than 11 inches water column. When testing the gas supply system at test pressures:

- **> 1/2 psi** - the refrigerator and its individual shutoff valve must be disconnected from the gas supply piping system.
- **≤ 1/2 psi** - the appliance must be isolated from the gas supply piping system by closing its individual manual shutoff valve.

If detailed instructions on the installation and connection to the gas supply are required, please contact your dealer or distributor.

### Testing LP gas safety shut off

The gas safety shut off must be tested after the refrigerator is connected to LP gas supply.

#### RM2354, RM2454, RM2554, DM2662, DM2663, DM2862, DM3862, NDM1062 & NDR1292

To test the gas safety shut off, follow these steps:

1. Start the refrigerator. Switch to GAS mode.
2. Check that the gas flame is lit and the GAS mode indicator lamp is on.
3. Close the manual gas shutoff valve at the back of the refrigerator.
4. Wait for approx. 6 minutes. The CHECK indicator lamp should be lit and the GAS mode indicator lamp should be off.
5. Remove the protection cover.
6. Open the manual gas shutoff valve. Do not change any button positions on the control panel.
7. Apply a non corrosive commercial bubble solution to the burner jet orifice. No bubbles should appear at the opening of the burner jet orifice. The presence of bubbles indicates a defective gas safety shutoff, and service is required.
8. If no bubbles are present at the burner jet orifice, rinse it with fresh water. Be careful not to damage the burner jet orifice.
9. Put back the cover.
10. Press the ON/OFF button off and then back on. Normal operation of the burner should return.
11. Allow the burner to operate for a minimum of five minutes.

#### RM2351, RM2451, RM2551, DM2652 & DM2852

To test the gas safety shut off, follow these steps:

1. Start the refrigerator without connecting to 120V AC.
2. Check that the gas flame is lit. In AUTO mode, the AUTO mode indicator lamp is on.
3. Follow steps 3-11 in the previous instruction.

# INSTALLATION INSTRUCTIONS

## Electrical connection

### 120 V AC connection

The refrigerator is equipped with a grounded three-prong plug for protection against shock hazards. It should be plugged directly into a properly grounded three-prong receptacle. **Do not cut or remove the grounding prong from this plug!**

The free length of the cord is 2 feet. It should be routed to avoid direct contact with the burner cover, flue cover or any other components that could damage the cord insulation.

To allow easy access through the vent door, it is recommended that the receptacle is placed like this:

- **RM2351 & RM2354**

To the left of the refrigerator and **4-6"** above the refrigerator mounting floor

- **RM2451, RM2454, RM2551, RM2554, DM2652 & DM2852**

To the left of the refrigerator and **6"** above the refrigerator mounting floor

- **DM2662, DM2663, DM2862, DM3862 & NDM1062**

To the left of the refrigerator and **3"** above the refrigerator mounting floor.

- **NDR1292**

To the right of the refrigerator and **10"** above the refrigerator mounting floor.

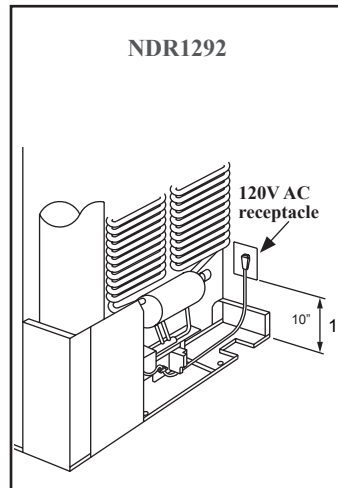
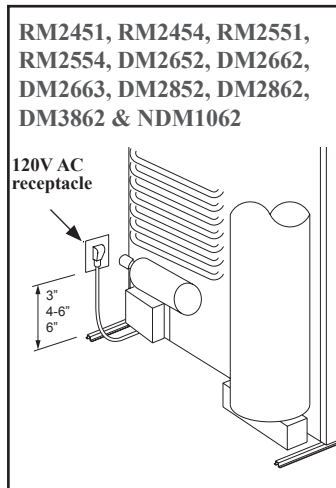

### 12V DC connection

**RM2451, RM2551, DM2652 & DM2852:** These refrigerator models are not designed for 12V DC operation of the cooling system. However, 12V DC must be supplied to operate the controls.

**RM2354, RM2454, RM2554, DM2662, DM2663, DM2862, DM3862 & NDM1062:** These refrigerator models require a continuous 12V DC supply to maintain the automatic energy system.

The connection is made to the positive (+) and negative (-) terminals of the terminal block on back of the refrigerator, see APPENDIX A - REARVIEW EQUIPMENT.

Correct polarity must be observed when connecting to the DC supply. Do not use the chassis or vehicle frame as one of the conductors. Connect two wires at the refrigerator and route to the DC supply. Ensure the connections are clean, tight and free from corrosion.

Ensure that the wires from the battery to the refrigerator are able to handle the load. The distance the current must travel from the battery to the refrigerator dictates the AWG wire size to be used. Inadequate wire sizes can result in a voltage drop which affects the refrigerator performance.

For 3-way models, the voltage drop affects the wattage output of the 12V cartridge heater and the refrigerator performance. The 12V DC heater is fused with a 30 amp. in-line blade fuse.

Recommended wire sizes are displayed in the following table:

MAXIMUM TOTAL CONDUCTOR WIRE LENGTH			
MODEL	WIRE	Length	
	Size AWG	ft	m
RM2351	14	17	5
RM2451	12	27	8
RM2551			
DM2652			
DM2662			
DM2852			
DM2862			
DM3862			
NDM1062			
NDR1292			
RM2354	10	17	5
RM2454	8	27	8
RM2554			
DM2663			

# MOUNTING INSTRUCTIONS

## REVERSING THE DOOR SWING

For all models, except **NDR1292**, the refrigerators are equipped with hinges that makes it possible to change the direction the door opens by moving the hinges to the opposite side. A special hinge kit must be used in order to change the door swing. For conversion kit number, refer to the USER MANUAL, APPENDIX A - SPARE PARTS. For additional information, please contact service point or distributor service dept. for assistance.

## MOUNTING THE DOOR PANEL(S)



Optional door insert panels are available for all models except **NDR1292**. The refrigerator is normally delivered without door panel(s).

Before starting the mounting work, read this instruction thoroughly and check that the panel dimensions are in compliance with those given in the following table:

PANEL DIMENSIONS max. thickness 5/32" (4 mm)					
		Height		Width	
		max	min	max	min
UPPER					
	mm	403	401	527	524
	inch	15-27/32	15-25/32	20-3/4	20-5/8
LOWER /SINGLE DOOR					
RM2351 RM2354	mm	667	665	498	496
	inch	26-17/64	26-3/16	19-5/8	19-17/32
RM2451 RM2454 DM2652 DM2662 DM2663	mm	827	825	527	524
	inch	32-9/16	32-1/2	20-3/4	20-5/8
RM2551 RM2554 DM2852 DM2862 NDM1062	mm	983	981	527	524
	inch	38-11/16	38-5/8	20-3/4	20-5/8
FROZEN FOOD COMPARTMENT					
NDR1292	mm	1402	1400	288	265
	inch	55-3/16	55-1/8	10-9/16	10-7/16
FRESH FOOD COMPARTMENT					
NDR1292	mm	1402	1400	430	427
	inch	55-3/16	55-1/8	16-15/16	16-13/16

## With screws

To mount the panel, follow these steps:



1. Open the door 90 degrees.
2. On new refrigerators, the decoration strip is taped inside the door; if installed on the door, remove the door decoration strip (2) by removing its three screws (1).  
**NDR1292:**  
Fresh food compartment door - remove three screws.  
Freezer compartment door - remove two screws.
3. Insert the vertical edges into the grooves of the door frame (3).
4. Push the panel downwards so that the lower horizontal edge of the panel (4) is fitted into the bottom groove (5).
5. Put the decoration strip across the door so that the gap is covered. Secure the decoration strip with the screws removed in step 2.

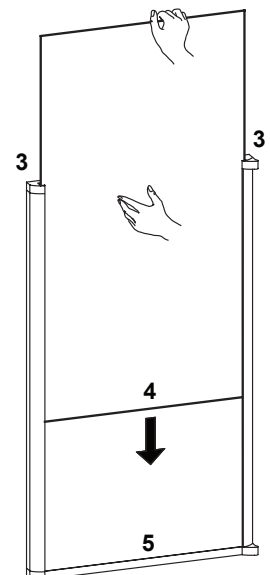
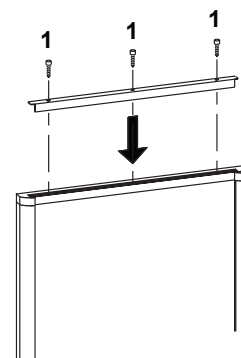
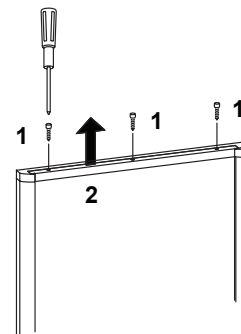

# MOUNTING INSTRUCTIONS

## Snap in

To mount the panel, follow these steps:

1. Open the door 90 degrees.
2. On new refrigerators, the decoration strip are taped inside the door; if installed on the door, remove the door decoration strip (2) by gently pushing the four tabs away with a flat blade screwdriver (1).
3. Insert the vertical edges into the grooves of the door frame (3).
4. Push the panel downwards so that the lower horizontal edge of the panel (4) is fitted into the bottom groove (5).
5. Snap in the decoration strip (2).

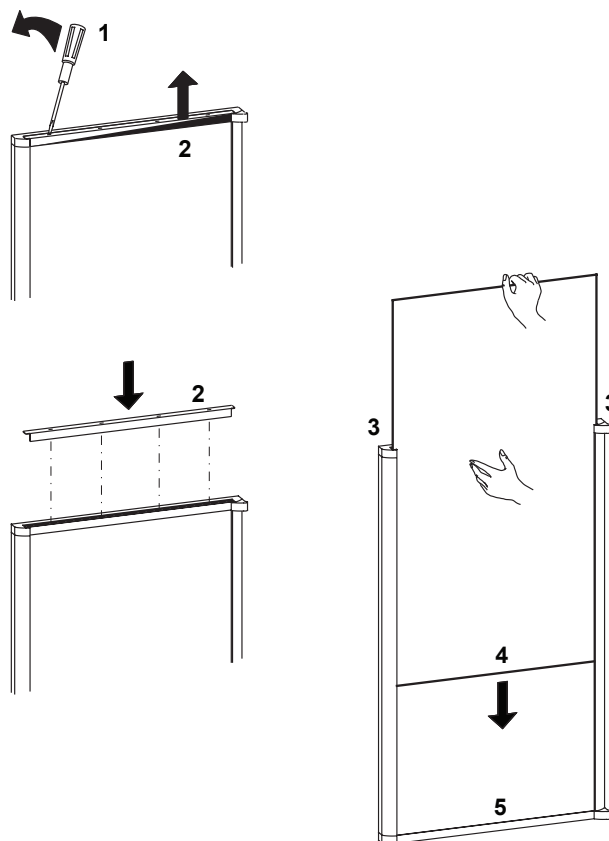

# REFRIGERATOR REMOVAL

Before removing the refrigerator:

- Verify that the AC and DC voltage leads are disconnected.
- Shut off the gas supply.
- Disconnect the gas supply line at the rear of the refrigerator. Always use a back up wrench when loosening and tightening connections.

To remove the refrigerator, follow these steps:

1. Cap the gas supply line.
2. Loosen the screws anchoring the refrigerator to the enclosure.
3. Slide the refrigerator out of the compartment.

Replacement is the reverse of removal. When reinstalling the refrigerator, make sure the sealing strips are properly positioned. Check all connections for gas leaks.

# APPENDIX A - REARVIEW EQUIPMENT

RM2351

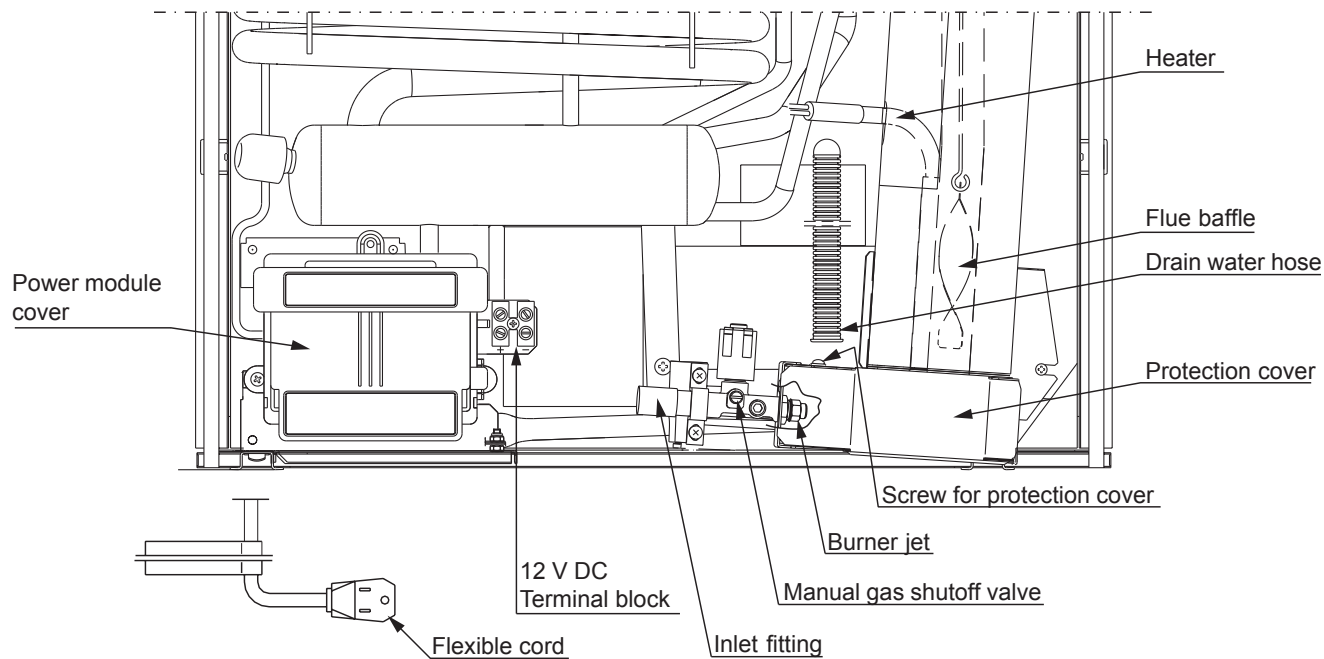

RM2354

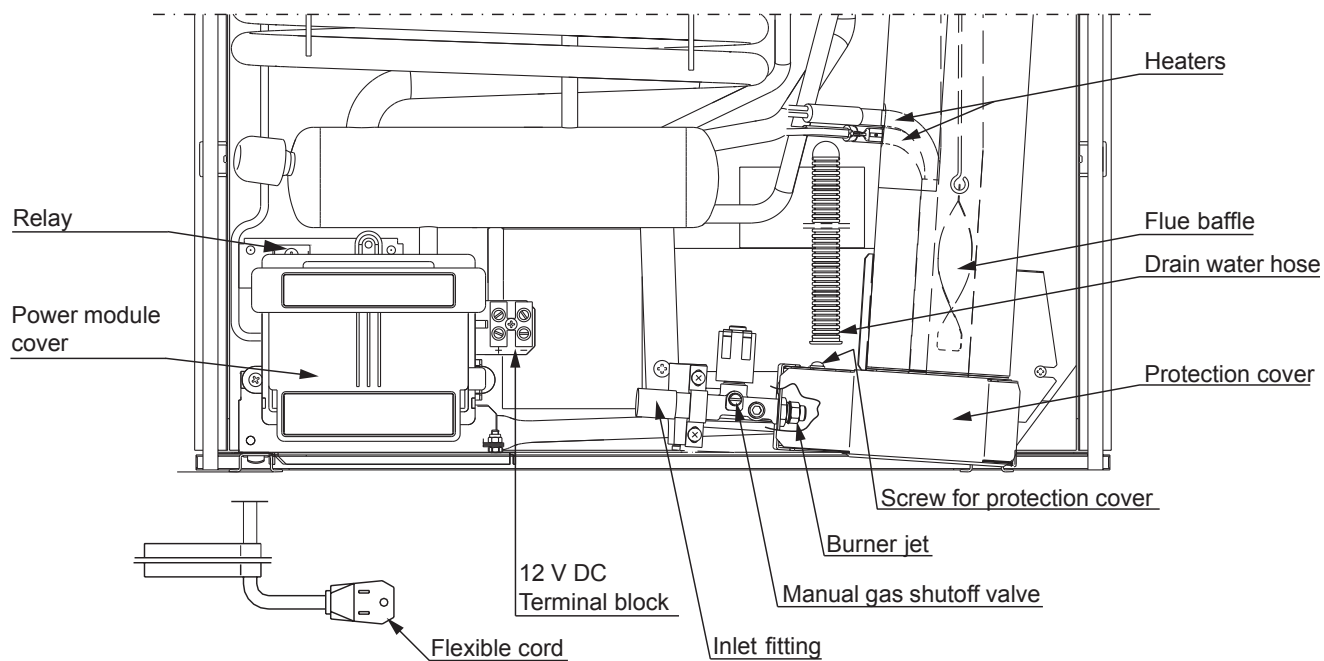

# APPENDIX A - REARVIEW EQUIPMENT

## RM2451, RM2454, RM2551 & RM2554

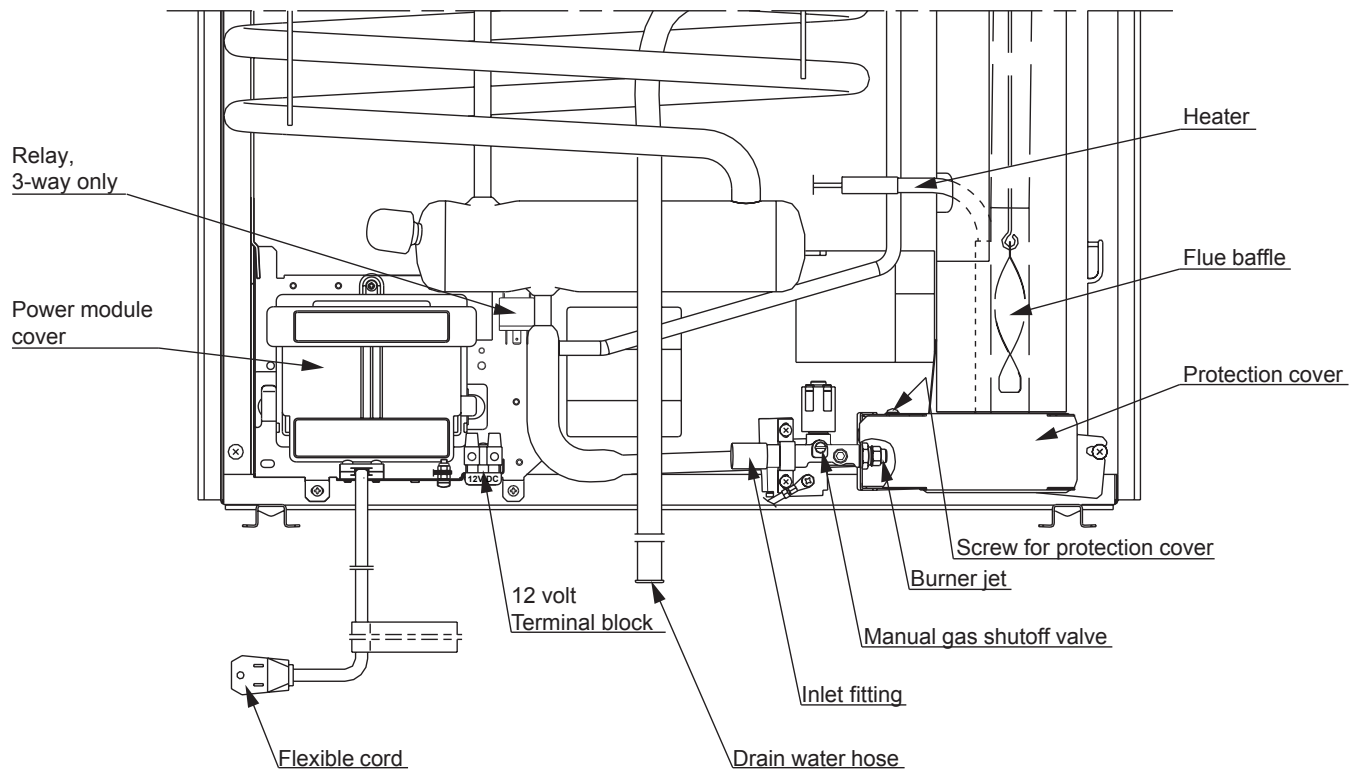

## DM2652, DM2662, DM2663, DM2852, DM2862, DM3862 & NDM1062

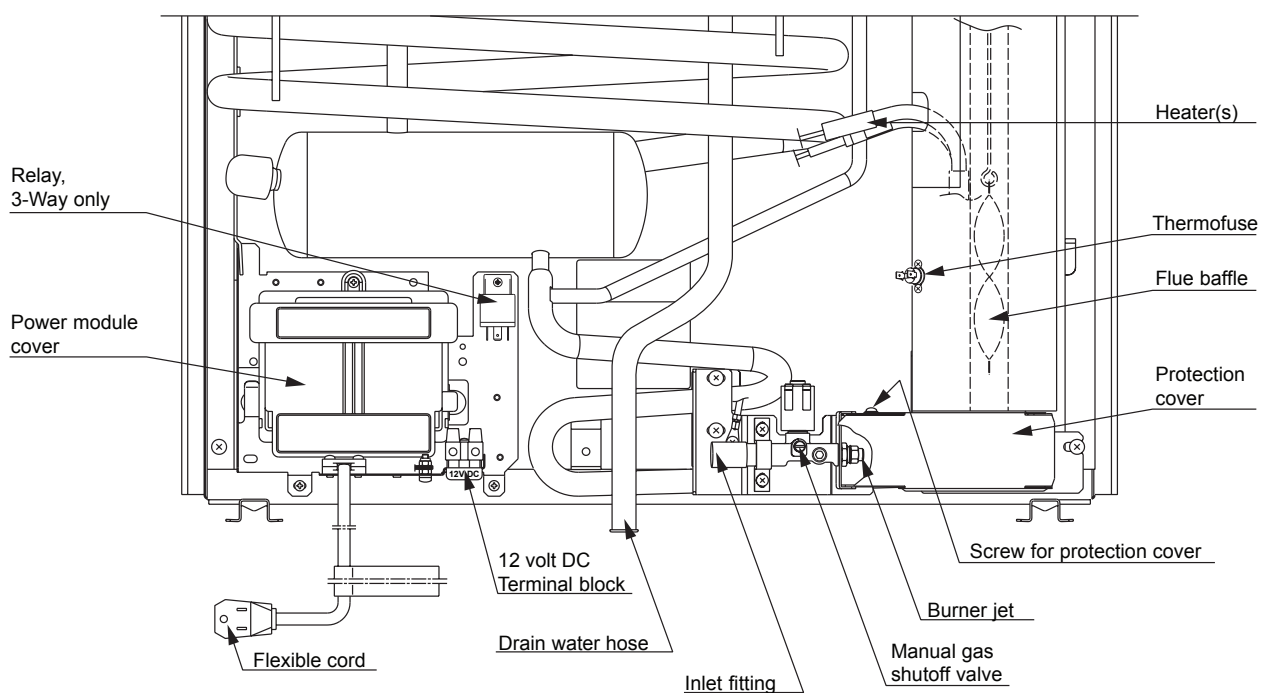

# APPENDIX A - REARVIEW EQUIPMENT

NDR1292

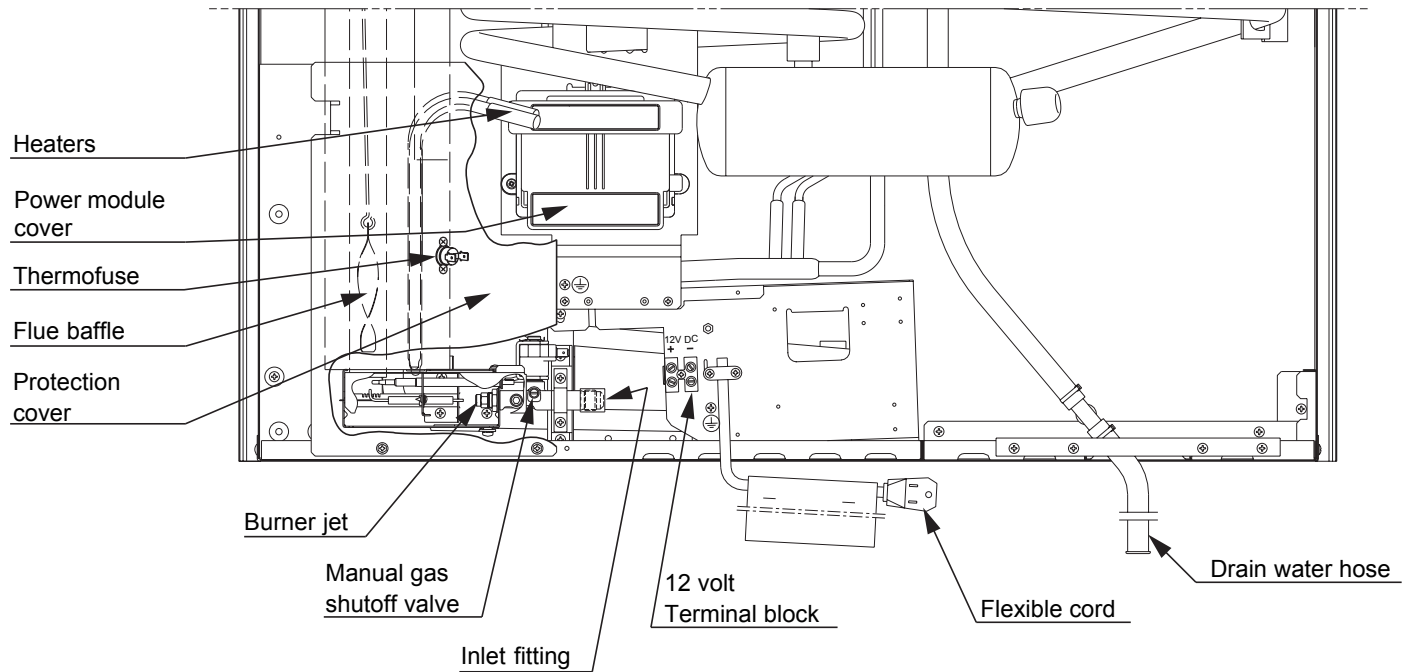

# APPENDIX B - WIRING DIAGRAMS

## RM2351, RM2451 & RM2551

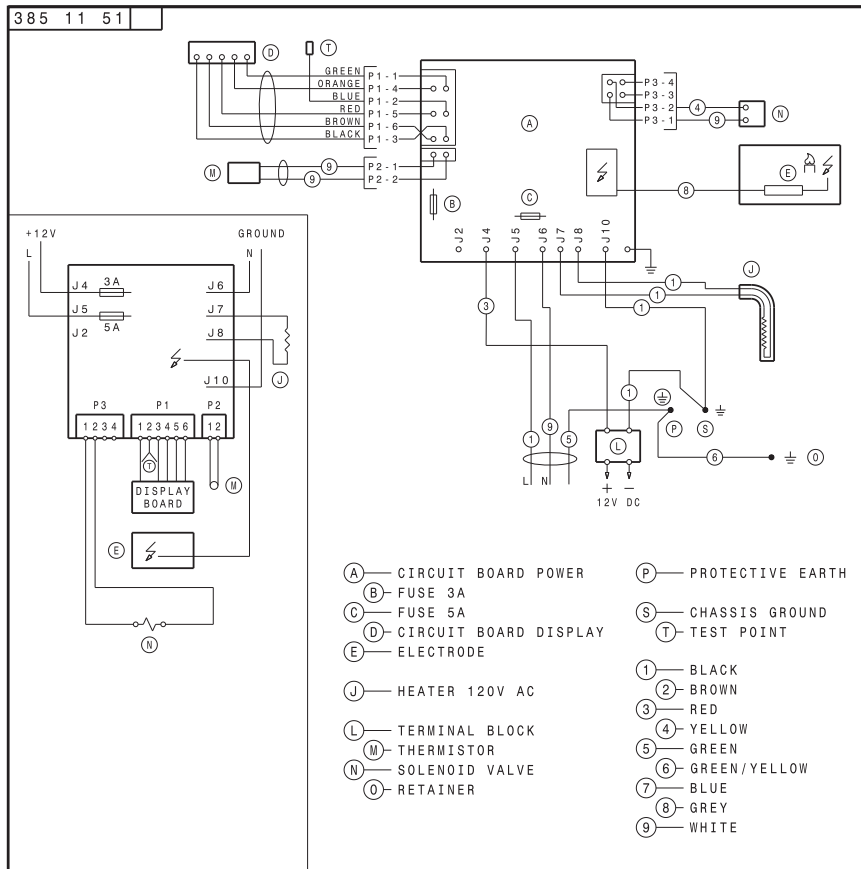

## RM2354, RM2454 & RM2554

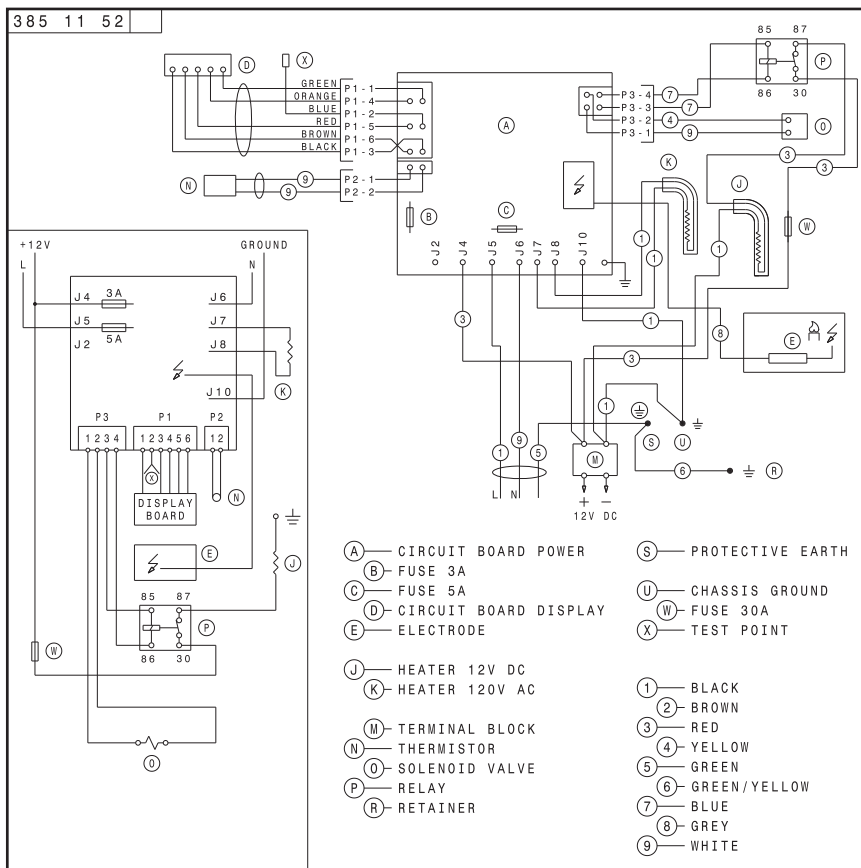



# APPENDIX B - WIRING DIAGRAMS

## DM2652, DM2662, DM2852 & DM2862

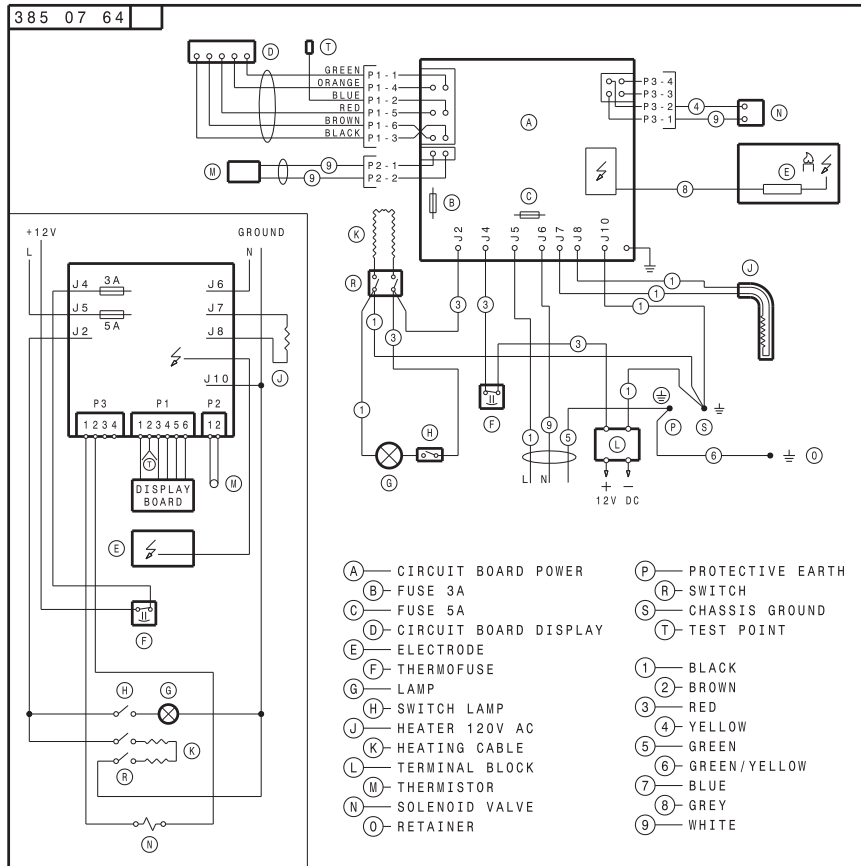

## DM2663

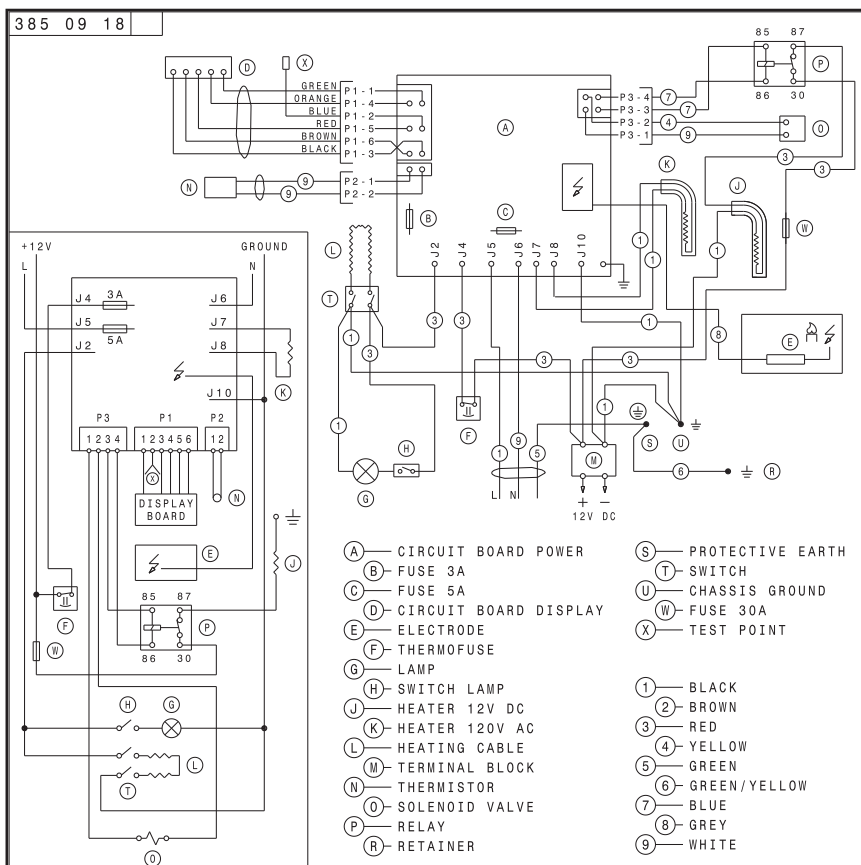

# APPENDIX B - WIRING DIAGRAMS

## DM3862 & NDM1062 (SS)\*

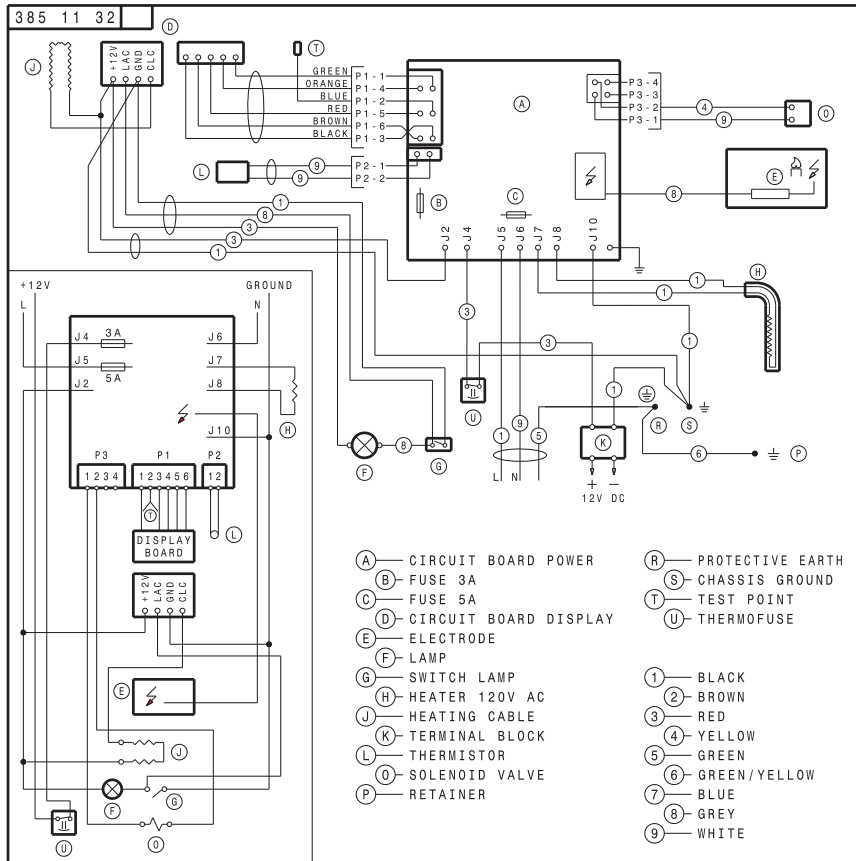

## NDM1062 (B)\*

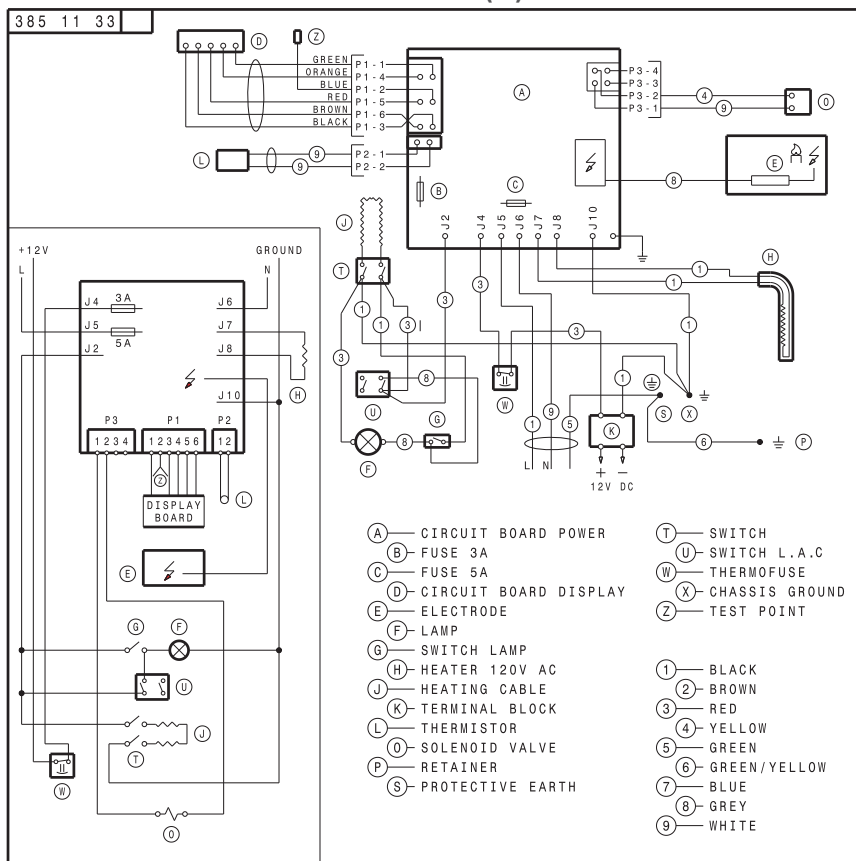

\* SS=Stainless steel doors  
B = Door insert panels



**TO THE INSTALLER**

PLEASE AFFIX THESE INSTRUCTIONS  
TO THE REFRIGERATOR

—

**TO THE CONSUMER**

PLEASE RETAIN THESE INSTRUCTIONS  
FOR FUTURE REFERENCE