



USA
SERVICE OFFICE
Dometic, LLC
2320 Industrial Parkway
Elkhart, IN 46516
574-294-2511

CANADA
Dometic, LLC
46 Zatonski, Unit 3
Brantford, ON N3T 5L8
CANADA
519-720-9578

**For Service Center
Assistance Call:**
800-544-4881

SLIDE TOPPER

REPLACEMENT INSTRUCTIONS FOR

FABRIC, TORSION ASSEMBLY, & ROLLER TUBE

⚠ WARNING

This manual must be read and understood before installation, adjustment, service, or maintenance is performed. This unit must be installed by a qualified service technician. Modification of this product can be extremely hazardous and could result in personal injury or property damage.

⚠ AVERTISSEMENT

Lire et comprendre ce manuel avant de procéder à l'installation, à des réglages, de l'entretien ou des réparations. L'installation de ce produit doit être effectuée par un réparateur qualifié. Toute modification de ce produit peut être extrêmement dangereuse et entraîner des blessures ou dommages matériels.

SERVICE INSTRUCTIONS

SLIDE TOPPER

REVISION

Form No. 3106819.075 09/11
(Replaces 3106819.068)
(French 3108510.045)
©2011 Dometic, LLC
LaGrange, IN 46761

SAFETY INSTRUCTIONS

This manual has safety information and instructions to help users eliminate or reduce the risk of accidents and injuries.

RECOGNIZE SAFETY INFORMATION



This is the safety alert symbol. It is used to alert you to personal injury hazards. Obey all safety messages that follow this symbol to avoid possible injury or death.

UNDERSTAND SIGNAL WORDS

A signal word, when used with the safety alert symbol, will identify a safety hazard and its level of risk for personal injury. A signal word, without the safety alert symbol, will be used for property damage messages only.

⚠ WARNING WARNING indicates a hazardous situation which, if not avoided, could result in death or serious injury.

⚠ CAUTION CAUTION, used with the safety alert symbol, indicates a hazardous situation which, if not avoided, could result in minor or moderate injury.

NOTICE NOTICE is used to address practices not related to personal injury.

GENERAL INSTRUCTIONS

⚠ WARNING

These instructions must be read and understood before installation of this kit. This kit must be installed by a Dometic, LLC Service Center or a qualified service technician. Modification of this product can be extremely hazardous and could result in death or serious injury.

Tools Required:

Screwdriver	Pop Rivet Tool
Pliers	Electric Drill
3/16" Drill Bit	1/8" Drill Bit
Stepladder	

The Slide Topper fabric roller tube assembly (FRTA) consists of a fabric, roller tube and two torsion assemblies. For proper Slide Topper Awning operation, the roller tube is under spring tension from the torsion assemblies.

⚠ WARNING

Use extreme care. Springs under tension are dangerous. If not controlled, they will unwind quickly. Keep hands and clothing clear of the end brackets. Failure to obey this warning could result in death or serious injury.

In all instances of fabric or roller tube replacement, it will be necessary to have a work area large enough to allow complete unrolling of the awning. This area must be clean and smooth so the awning fabric will not be damaged.

Important: It may not be necessary to remove the Slide Topper from the slide-out-room when replacing a fabric assembly on an Elite or Deluxe Slide Topper. If end cap slots align with roller tube poly rope channel there is no need to remove the Elite or Deluxe Slide Topper from slide-out-room. If they are aligned follow instructions in Section C, paragraph 1; steps "a" through "e" and Section E, paragraph 1; steps "a" through "e". If they are not aligned start at Section A.

⚠ WARNING

Read and follow all safety information and instructions to avoid possible injury or death.

INSTALLATION INSTRUCTIONS

A. Slide Topper Removal

In all cases of torsion assembly, roller tube, and Elite Full Cover fabric assembly replacement the Slide Topper must be removed from the slide-out-room. Fully retract the slide-out-room to the transport position before removing the Slide Topper.

1. Remove the TEK screws securing the awning fabric/aluminum guard at each end of the awning rail. See FIG. 1 and 2.

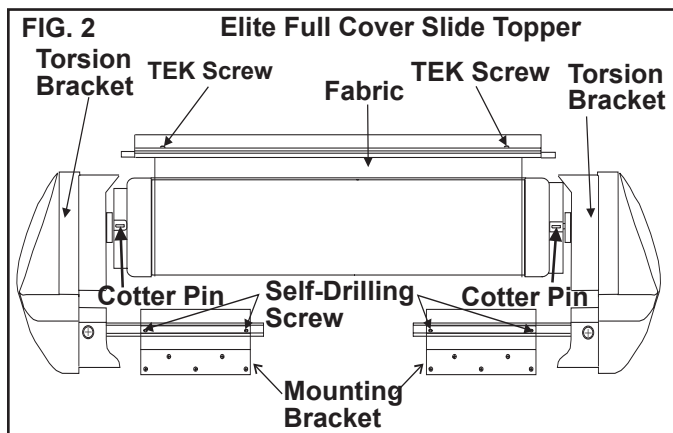
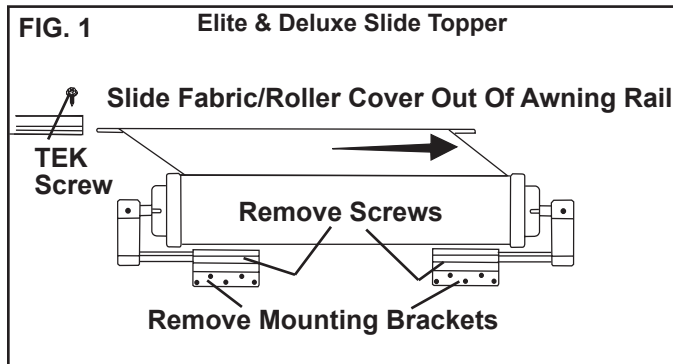

2. On Elite Full Cover Slide Topper it is necessary to remove the cover at this time.
 - a. Remove the two (2) screws in the center support bracket. See FIG. 3.
 - b. Remove the four (4) pan head screws in the cover. See FIG. 3.
 - c. Grasp the cover at the bottom edge near one end of the torsion bracket and pry the cover up approximately 1-2" with one hand while holding the torsion bracket with the other hand. Repeat the same process at the other end and continue lifting the cover until it can be fully removed. See FIG. 3.
 - d. Place the cover in an area where it will not be damaged.

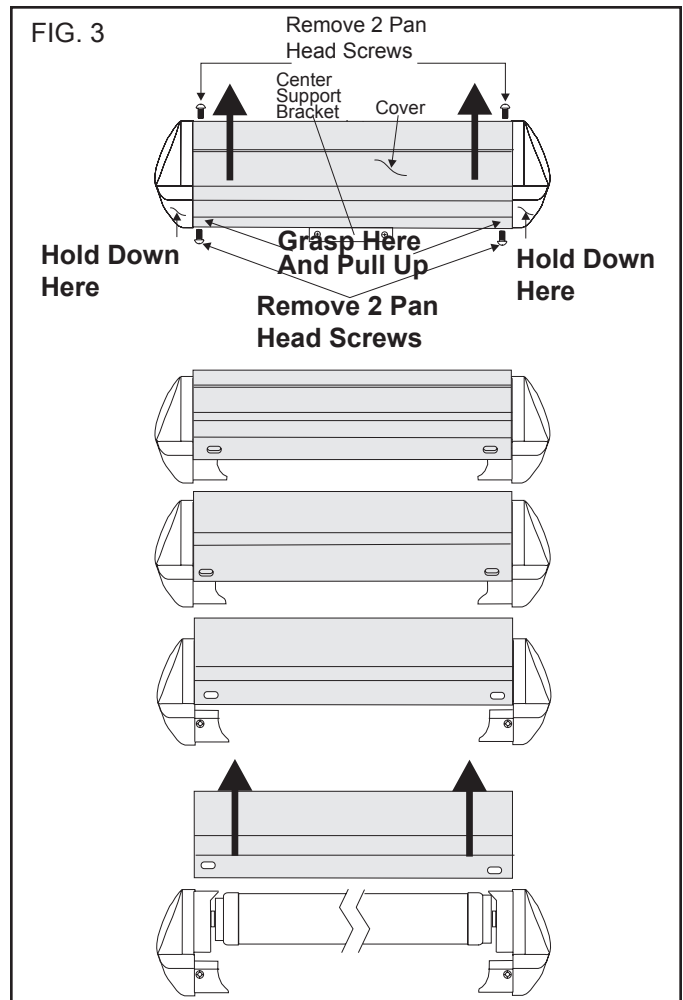

3. Insert a 7/64" x 2-3/4" cotter pin (provided) into each end cap and through the hole in the torsion rod. It may be necessary to turn the roller tube and slide the end bracket toward or away from the FRTA to align the hole in the torsion rod. See FIG. 2 & 4. Bend the pin to prevent it from falling out. Repeat on the opposite end.

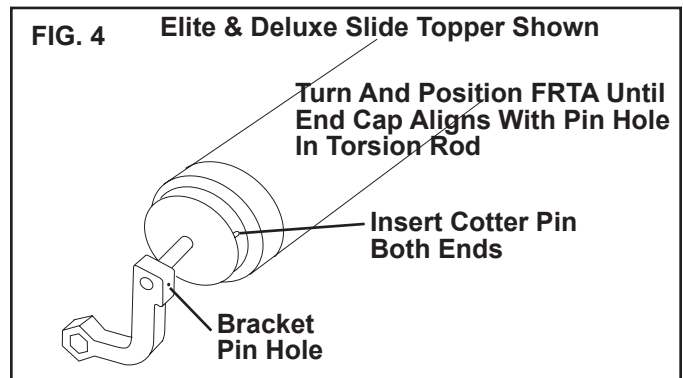

4. Remove both self-drilling screws holding the two (2) hex extension bars in the mounting brackets. See FIG. 1 & 2.
5. Remove both mounting brackets from the slide-out-room. See FIG. 1 & 2.
6. Slide the Slide Topper out of the awning rail. This may require two people.

B. Torsion Assembly Unwinding And Removal

1. Remove Slide Topper awning from the slide-out-room. See Section A, "Slide Topper Removal", Steps 1-6.

⚠ WARNING

Do not remove the cotter pin located on each end of the FRTA until instructed to do so. The FRTA is pre-wound and under tension. Rapid spin-off will occur if the cotter pin is removed. Failure to obey this warning could result in death or serious injury.

2. Remove hex extension bar.
 - a. Elite and Deluxe Slide Topper
 - Drill the 3/16" x 3/8" pop rivet out of end bracket. This will allow the hex extension bar to be removed and inserted from the other side. It will then act as a crank handle. See FIG. 5. Repeat this step if the other torsion needs to be removed.

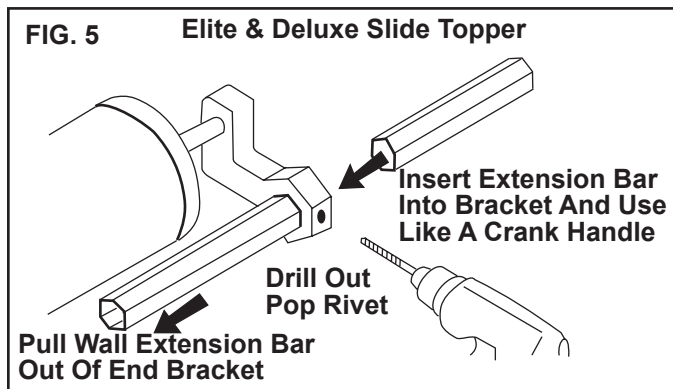

- Two people are required to unwind the torsion spring. Have one person hold the awning tube. The second person will tightly grasp the hex extension bar and remove the cotter pin. See FIG. 6.
- While controlling the hex extension bar slowly unwind the torsion spring. See FIG. 6.

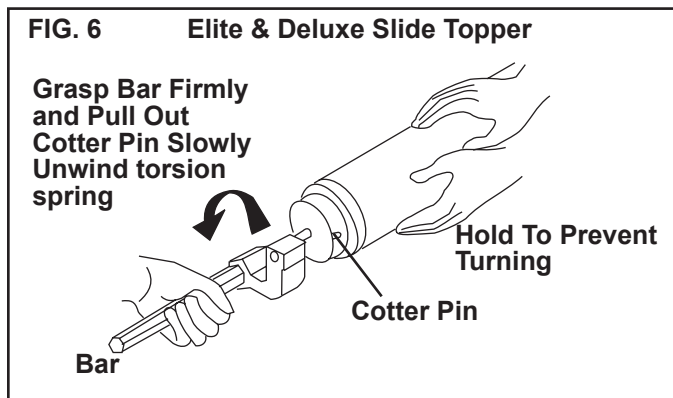

- b. Elite Full Cover Slide Topper

- Remove the self-tapping screw from the torsion bracket. Remove the hex extension bar from the torsion bracket. See FIG. 7.

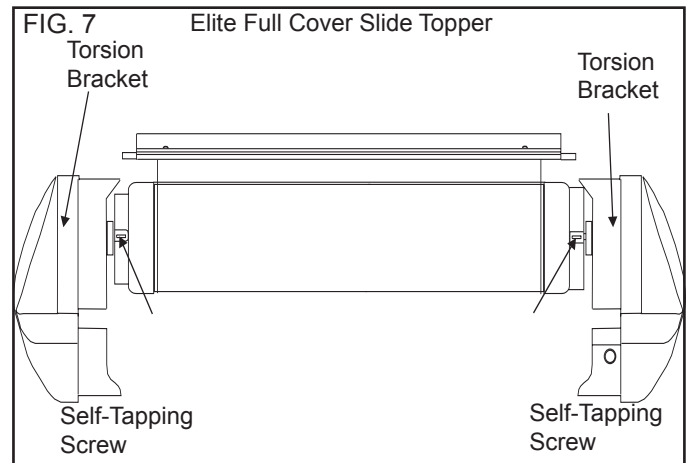

- Place the FRTA on a work bench and secure to bench with C-clamp as shown in FIG. 8.

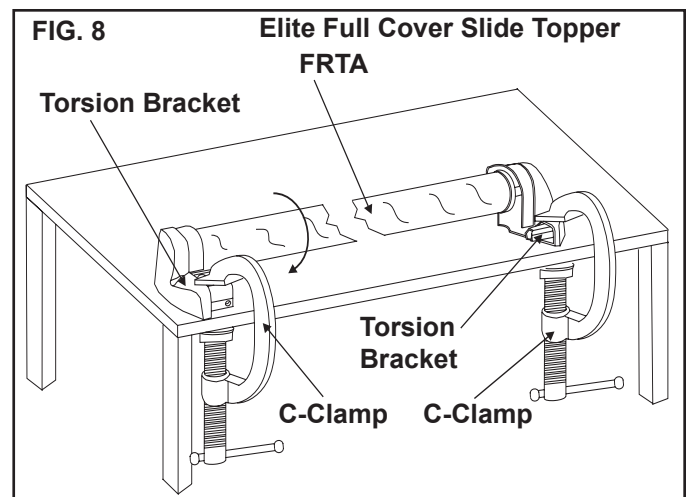

- Two people are required to unwind the torsion. Have one person tightly grasp the FRTA. The second person will now remove both cotter pins. See FIG. 2.
 - While controlling the FRTA, slowly allow the torsion spring to unwind.
3. Drill out pop rivets that attach the end cap to the roller tube. Pull the torsion out from the roller tube.

C. Fabric Assembly Removal

1. Elite and Deluxe Slide Topper installed on slide-out-room
 - a. Fully extend the slide-out-room.
 - b. Remove the TEK screws securing the awning fabric/aluminum guard at each end of the awning rail. (See FIG. 9 and 10)

FIG. 9

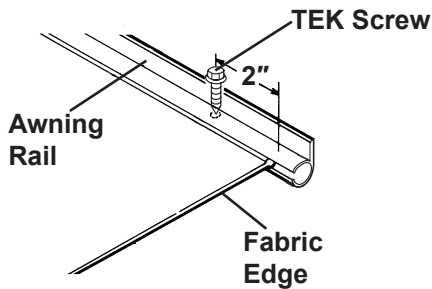
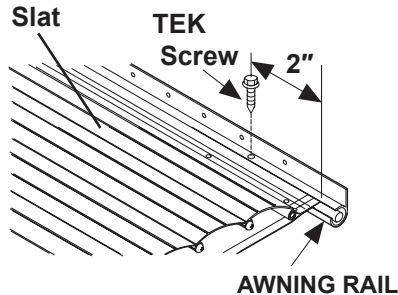

FIG. 10



⚠ WARNING

When utilizing a step ladder for this procedure, follow step ladder manufacturer's safety warnings. Failure to obey manufacturer's instructions could result in death or serious injury.

- c. Position the step ladder in front of the slide-out-room at either end of the awning. Using both hands grasp the roller tube firmly. Carefully rotate the roller tube, which is under tension, to unroll the fabric assembly completely. Keep one hand firmly on the tube to prevent it from rotating.
- d. While firmly holding the tube insert a 7/64" x 2-3/4" cotter pin (provided) into the end cap and through the hole in the torsion rod. It may be necessary to turn the roller tube slightly to align the hole in the torsion rod. See FIG. 11. Bend the pin to prevent it from falling out. Repeat on the opposite end.

FIG. 11 Elite & Deluxe Slide Topper Shown

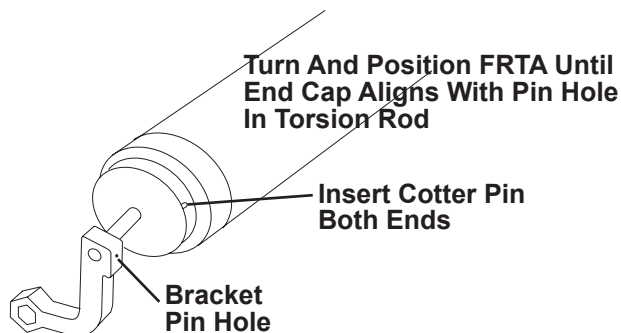

⚠ WARNING

Do not remove the cotter pin located on each end of the FRTA until instructed to do so. The FRTA is pre-wound and under tension. Rapid spin-off will occur if the cotter pin is removed. Failure to obey this warning could result in death or serious injury.

- e. Remove Fabric Assembly From Roller Tube
 - If poly rope channel aligns with the slot in the end cap remove tape holding fabric in place. See FIG. 12. Slide the fabric out of the roller tube channel and awning rail. This may require two people.
 - If poly rope channel is not aligned with slot in end cap the torsion assembly must be removed. Stop and go back to Section A.

Important: If poly rope channel is not aligned with slot in end cap follow all instructions beginning with Section A.

FIG. 12

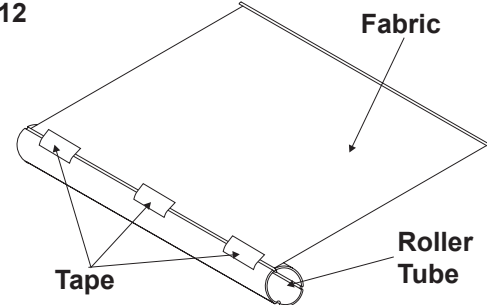

2. (Deluxe, Elite, and Elite Full Cover) Slide Topper has been removed from slide-out-room.

Important: Complete Sections A & B before doing this step.

- a. Remove Fabric Assembly From Roller Tube
 - Unroll fabric assembly. Remove tape holding fabric in place and slide the fabric out of the roller tube channel. See FIG. 12.

D. Roller Tube Removal

1. Remove Slide Topper from slide-out-room. See Section A, "Slide Topper Removal", Steps 1–6.
2. Remove both torsions. See Section B, "Torsion Assembly Unwinding And Removal".
3. Remove fabric assembly. See Section C, "Fabric Assembly Removal", Steps 1–2.

E. Fabric Assembly Installation

1. Elite and Deluxe Slide Topper installed on slide-out-room
 - a. Be sure the new fabric assembly is the correct size and color.

- b. Slide the top edge of the awning fabric into the awning rail and begin sliding it into position. This may require two people.
- c. Slide the bottom edge of the fabric into the end cap slot and roller tube channel. Filing may be necessary to ensure that the fabric slides smoothly into the roller tube channel and to prevent damage. Center the fabric assembly on the roller tube and tape in place. See FIG. 12. Trim off any poly rope protruding from the roller tube.
- d. Straighten and then remove the cotter pins from both sides of the awning. Check that the awning tube is free to rotate by rotating it slightly by hand. If the tube is free to rotate, you can now retract the slide-out-room.

⚠ CAUTION

DO NOT operate your slide out room without first checking that there are no people or objects in the path of the room or the Slide Topper. Failure to obey this caution could result in injury.

- e. Open and close the room several times to allow the fabric to become centered in the awning rail. Once the fabric is centered, secure it by reinstalling the TEK screws through the awning rail on both sides of the canopy (or slat assembly) so that it cannot shift from side to side. (See FIG. 13).

FIG. 13

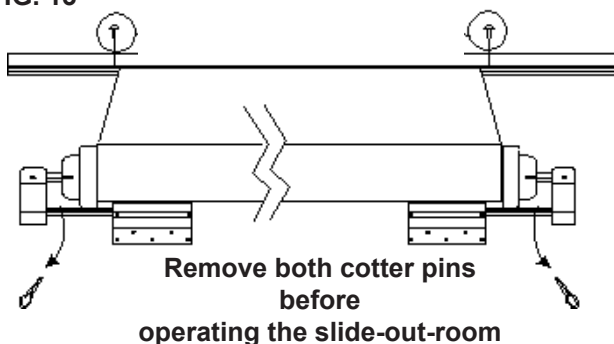

2. (Deluxe, Elite, and Elite Full Cover) Slide Topper has been removed from slide-out-room.
 - a. Be sure the new fabric assembly is the correct size and color. If roller tube is being replaced, make sure it is the correct length.
 - b. If your roller tube is new, the fabric assembly can be placed in any one of the three channels. If you are placing a new fabric assembly onto an existing roller tube, the fabric is placed into the same channel from which the old fabric was removed. This eliminates the need to drill new holes.

- c. Center the fabric assembly on the roller tube and tape in place. See FIG. 12. Hand-roll the entire assembly in the same direction as the original fabric assembly. See FIG. 14. Trim off any poly rope protruding from the roller tube.

FIG. 14 Elite & Deluxe Slide Topper Shown

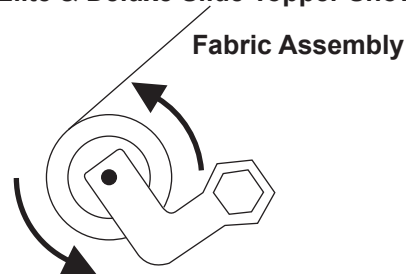

Right Hand Side End Bracket

F. Installing Torsion Assembly

Important: If a new torsion is being installed, make sure the end brackets are the same height. If the opposite torsion has a bracket of different height, it must be replaced to allow the Slide Topper to operate.

1. Reinstall the torsion assembly in the roller tube. Align the rivet slots on the end cap with the holes in the roller tube.
2. If the roller tube is new, rivet holes will need to be drilled. Drill 1/8" holes in the 1-13/16" diameter roller tube. Drill 3/16" holes in the 2-1/2" diameter roller tube. Use the end cap as a template to locate the holes. The open slot in the end caps should line up with the channel holding the fabric on both ends of the tube.
3. Secure end cap to roller tube with three pop rivets of the proper size: 1/8" x 1/4" aluminum pop rivet for 1-13/16" roller tube, 3/16" x 3/8" aluminum pop rivet for 2-1/2" roller tube

FIG. 15A Elite & Deluxe Slide Topper Right End Cap

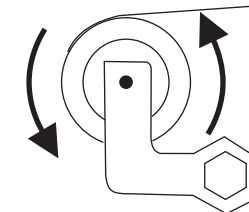
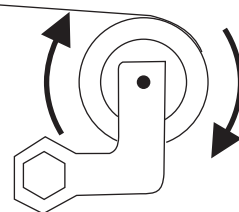

FIG. 15B

Left End Cap



Length (inches)	All
Turns	13

G. Rewinding Torsion Springs

1. Elite & Deluxe Slide Topper
 - a. When facing the awning, the end bracket on the right is to be turned counter-clock-wise. See FIG. 15A. The end bracket on the left is turned clock-wise. See FIG. 15B.
 - b. While controlling the hex extension bar turn the end bracket the number of turns specified in the chart above. Two people are required for this procedure. See FIG. 16.

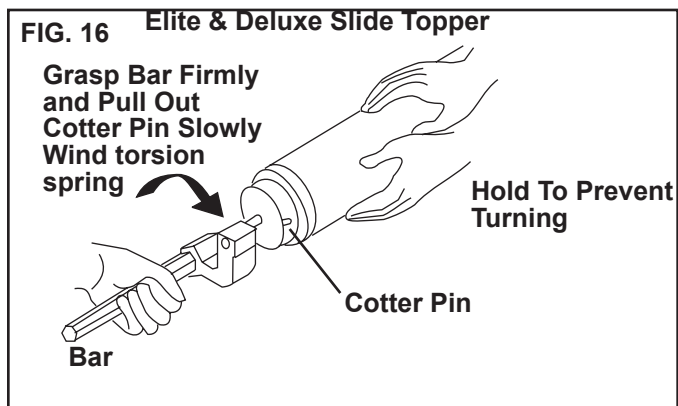

- c. Insert the cotter pin into the end cap and through the hole in the torsion rod to lock spring tension into torsion. See FIG. 16. It may be necessary to slide the end bracket toward or away from the FRTA to align the hole in the torsion rod.

Important: Make sure the end brackets are in the same position on each end of the roller tube.

- d. To reinstall the Slide Topper refer to the Installation Instructions received with the Slide Topper.
2. Elite Full Cover Slide Topper
 - a. Place the entire FRTA on a work bench and secure to bench with C- Clamp as shown in FIG. 17.

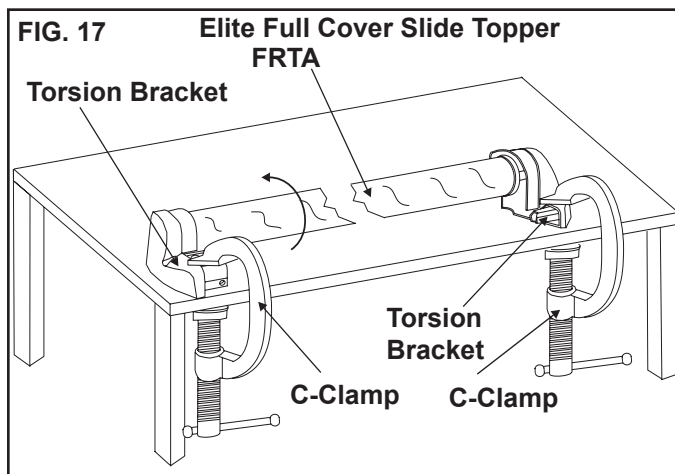

- b. While standing in front of the FRTA, roll the FRTA away from you the number of turns specified in the chart below. Two people are required for this procedure.
 - c. Insert the cotter pin into the end cap and through the hole in the torsion rod to lock spring tension into torsion. See FIG. 18. It may be necessary to slide the end bracket toward or away from the FRTA to align the hole in the torsion rod.
 - d. To reinstall the Slide Topper refer to the installation Instructions received with the Slide Topper.

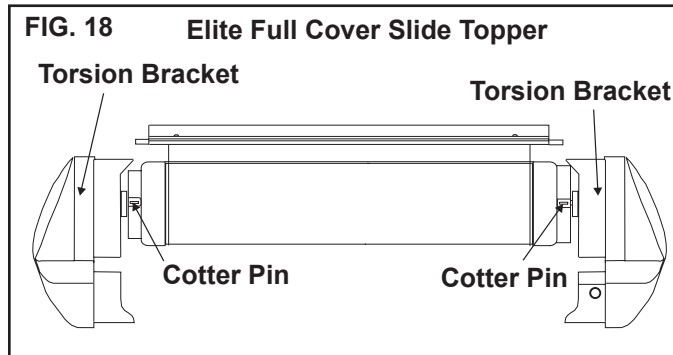

Length (inches)	All
Turns	13