

Georgetown 370TS Motorhome 120 Volt GFIC Circuit

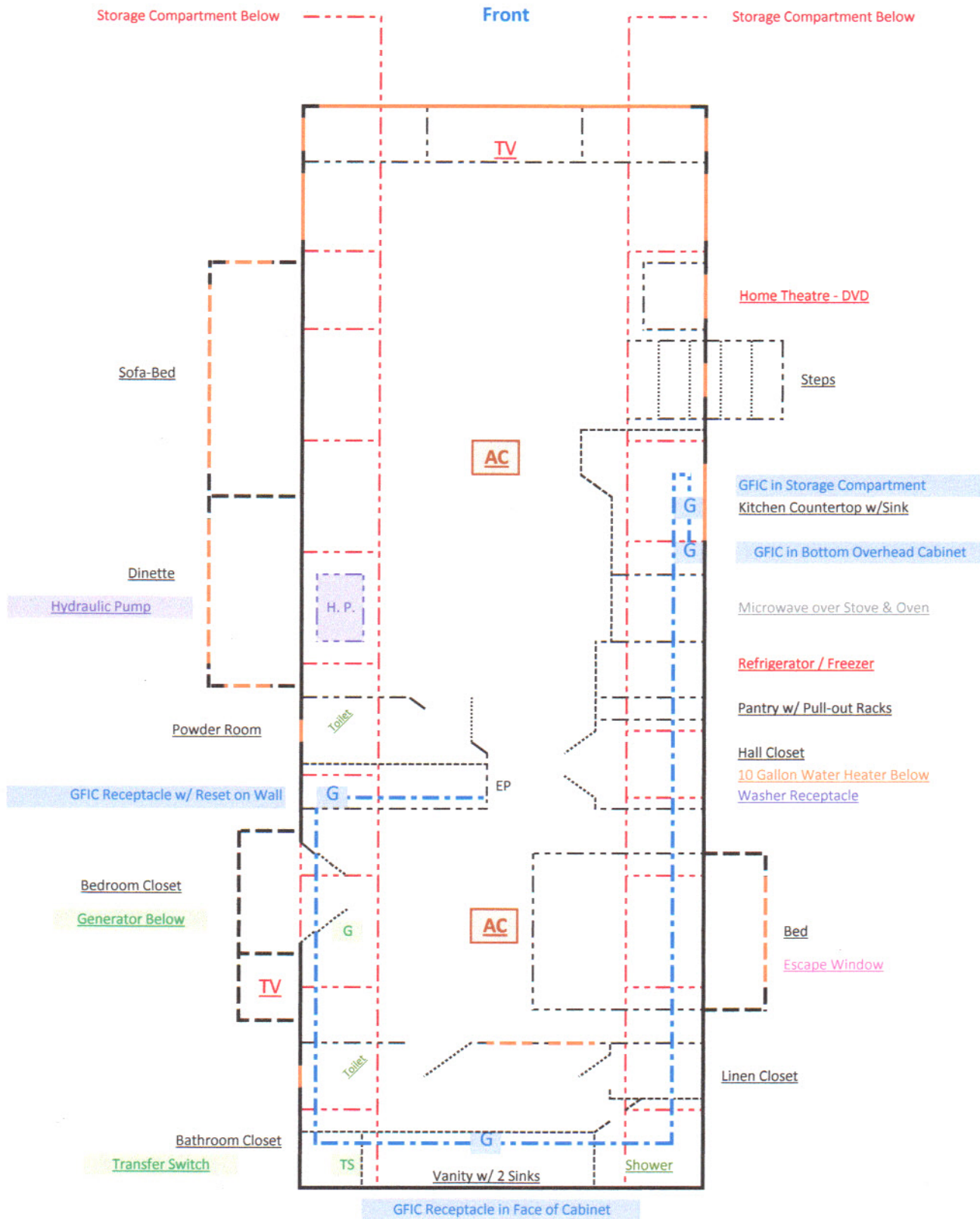

Wire leaves Electrical Panel and goes up in the wall in the Powder Room to the GFIC Receptacle, from there it travels back down the wall then turns and runs to the rear through a bulkhead at the floor, it makes a turn at the rear under the cabinets and runs to the GFIC receptacle in the face of the Bathroom Vanity. The wire continues from that Receptacle to the passenger side and travels along the floor towards the front then turns down into the storage compartment to pick up the Receptacle in there. From there it runs back up and travels again across the floor behind the Kitchen cabinets. It then turns up in the wall near the refrigerator and over to the receptacle in the bottom of the Kitchen cabinet.

GFIC Circuit is powered through a 20 amp Single Pole Homeline Breaker in the Electrical Panel.

Georgetown 370TS Motorhome Washer Water Heater Circuits

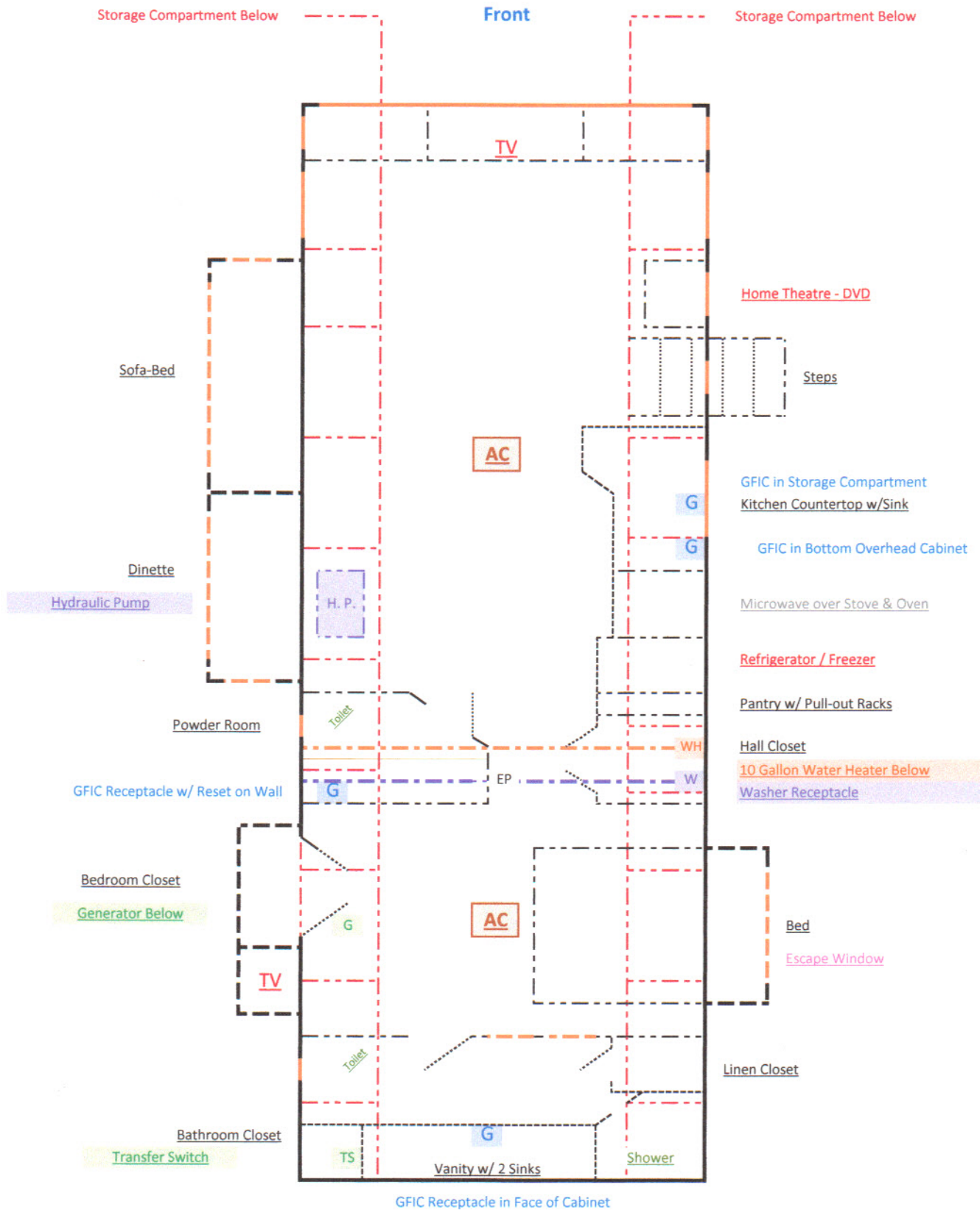

Both Water Heater & Washer circuits leave the back of the Electrical panel and run toward driver's side wall, turn into floor bulkhead and run forward. From there both jump up inside the water filter compartment area and run between the grey & black water tanks to the other side. The Water Heater circuit runs straight into the water heater compartment. Washer circuit turns up through the floor and runs in the back of the lower cabinet and turns up in the wall to the Receptacle.

Storage Compartment Below

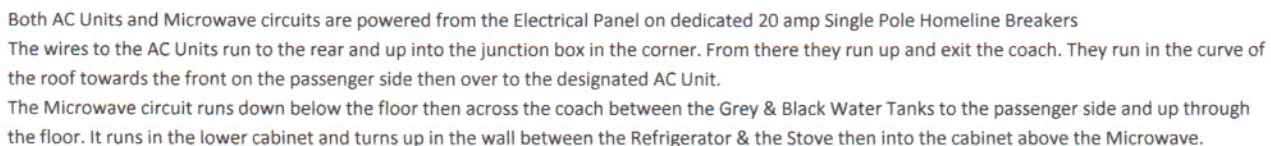

Georgetown 370TS Motorhome 20 Amp Receptacle Circuit Layout

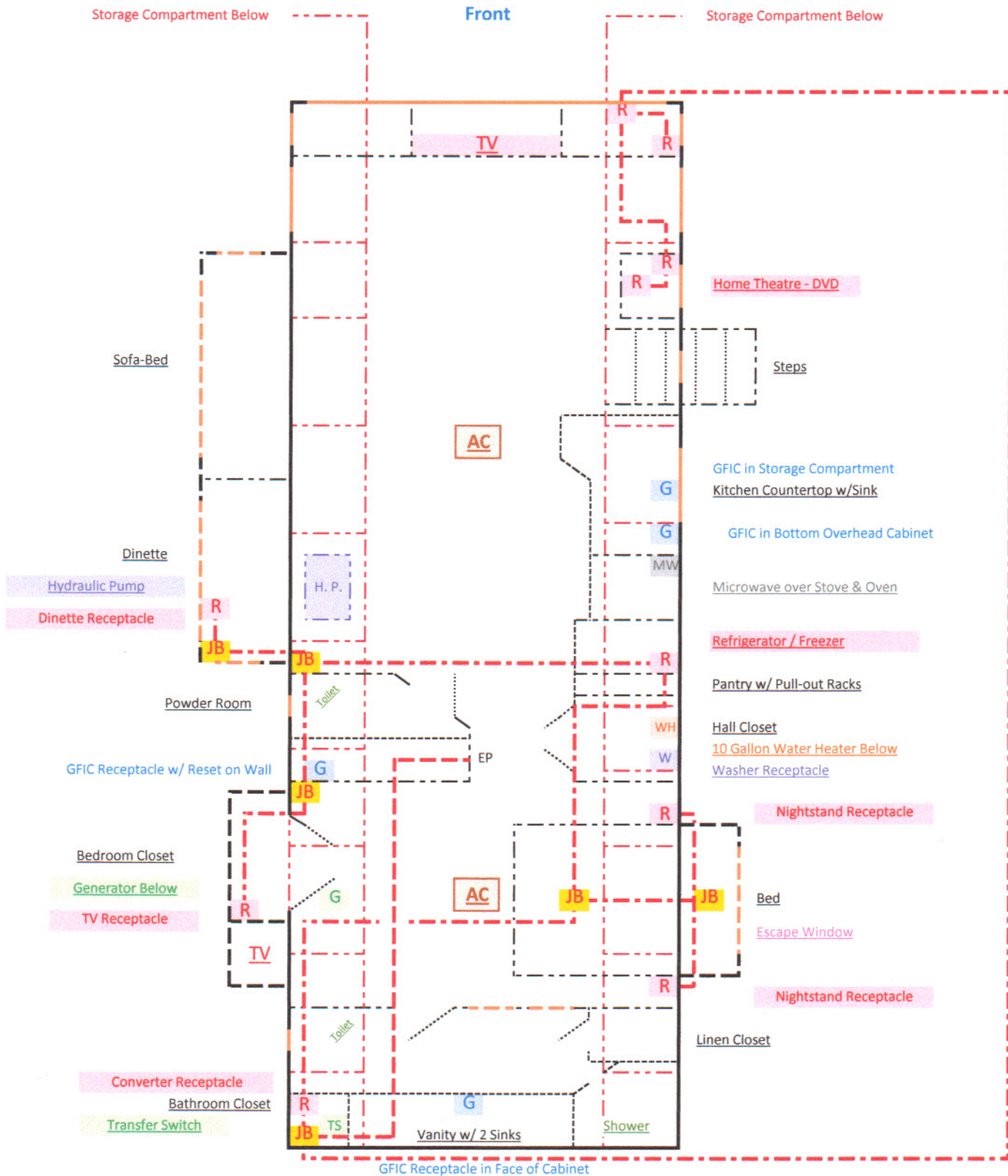

20 amp circuit leaves Electrical Panel, runs beneath the floor to Main Junction Box at rear in cabinet. It feeds off in 2 directions. One feed runs up the back of the coach into the curve of the roof and proceeds forward to front cap on the Passenger side. It ties into the Receptacle for the TV and branches in 2 directions. 1 line runs down the column to the Under-Dash Receptacle and the other runs over to the Home Theatre Receptacle. The wire continues through the HT Receptacle to the Receptacle under the cabinet. The Second feed from the Main Junction Box feeds down into the storage compartment to the Converter Receptacle. It proceeds through that Receptacle over to the Junction Box under the bed. This Junction Box splits into 2 feeds. 1 runs to the Junction Box at the head of the bed which feeds the 2 Nightstand Receptacles. The other feed runs over and through the Refrigerator Receptacle back down and over to the Junction Box for the Dinette Receptacle and also over for the Rear TV Receptacle after joining in the JB in the Bedroom.

Motorhome 120 Volt Electrical Footprint

R - Receptacle - Main Feed, Under Dash and Home Theatre Receptacles Junction Here

Front

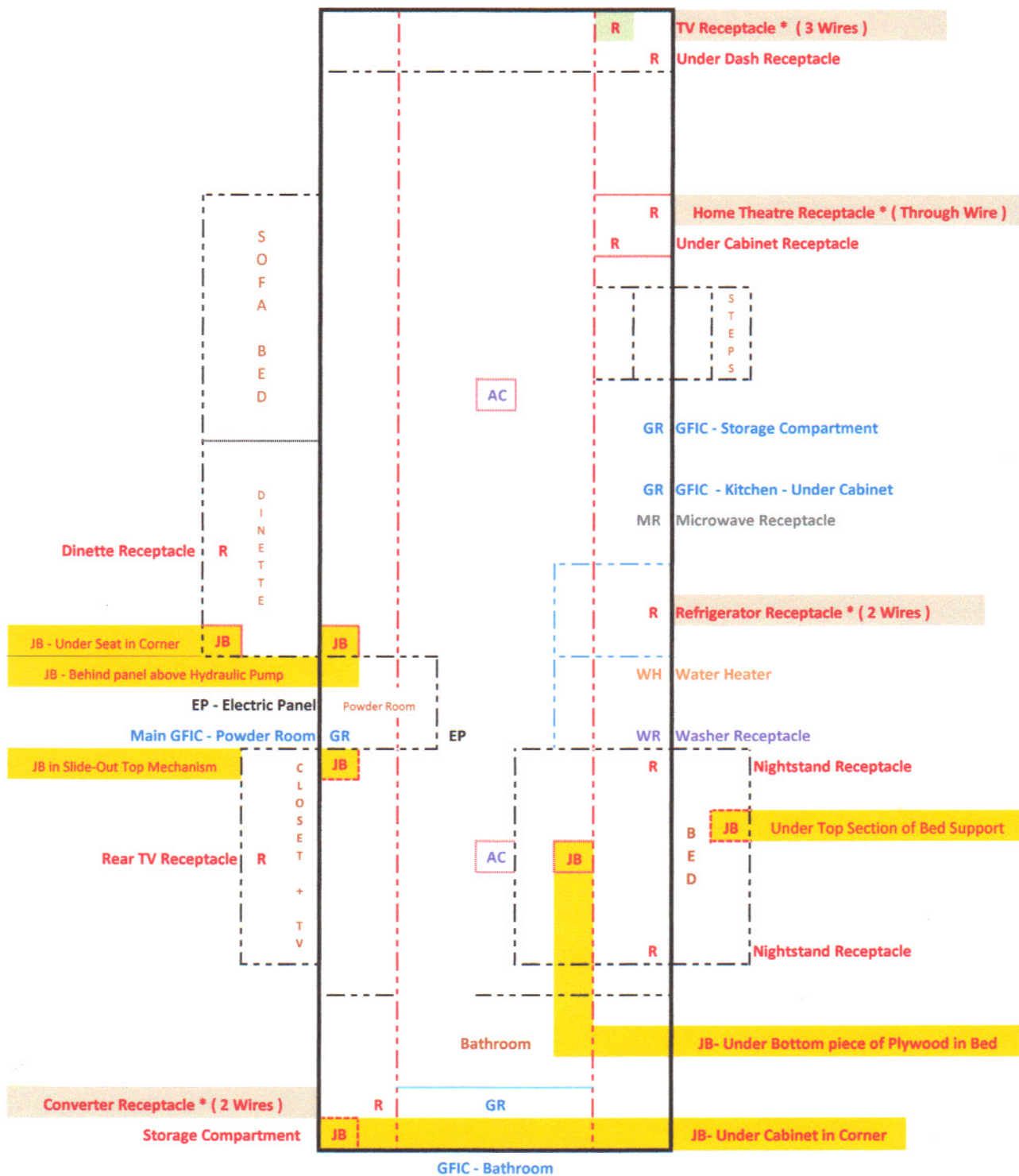

All Red Receptacles are on the same 20 amp circuit breaker

* - Junction Receptacle with at least 2 wires connected

JB - Junction Box