

Gen II 360 Siphon

Improvements for the new 360 Siphon: The top of the lid follows the very important shape on the bottom, eliminating the extra part to create the domed look on the top. Due to a smaller base diameter the lid can also be reduced, as shadowed in the picture below, without sacrificing performance. In fact this unit has almost 15% improved draw rate, important when two or more tanks are vented thru one stack

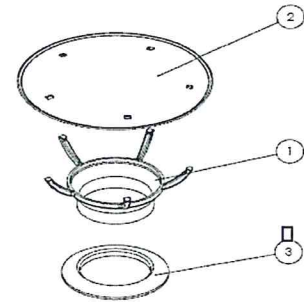
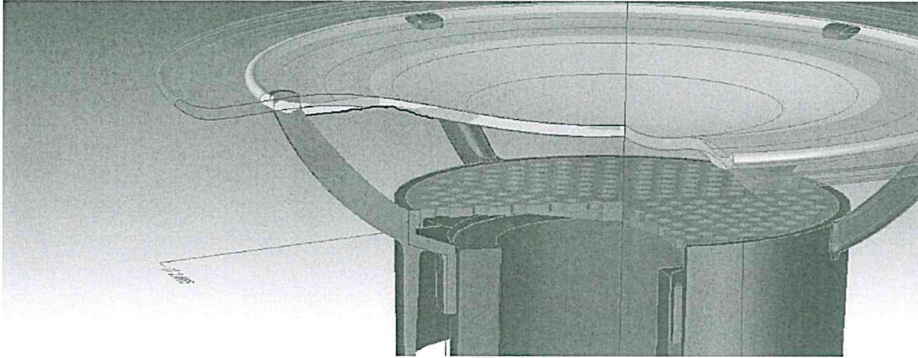

Installation

This is an extremely clean and fast install, for both OEM and AM, with no screws or holes required in the roof. The collar on the bottom is safety net to insure seal the between the stack and roof membrane is never compromised. A funnel as on Gen 1 is not required due to the base attaches directly onto the stack, stack height is not an issue. Due to the aerodynamic shape there is basically no wind loading on the unit. The base presses onto a 1 ½" or 2" stack, requiring minimum adhesive. One of the biggest advantages for the aftermarket when the vents are either to close together, or if one vent has to be lowered or raised to clear an object. Compared to standard vent install, only a portion of the sealant is required. In addition the lid will now be shadowing the roof sealant from the sun, prolonging the life of the water barrier. The longer funnel allows for easier installs on existing cap conversions.

Construction Details

- The lid snaps onto to the legs with a robotic press. There are small teeth on the top of each leg that bite into the lid. If pulled hard enough the lid will break free. This extreme force will break off a couple teeth. The lid can be pressed back on by hand, but it will not be as strong as originally
- Polycarbonate Construction. Rugged with UV protection for long life
- The bug screen is engineered to break water surface tension and to minimize airflow loss to an absolute minimum. The legs are also redesigned to almost eliminate wind turbulence
- The port, base, and lid is much improved over the gen1 Siphon, creating a higher draw rate and light wind sensitivity.
- The included flat washer helps with both OEM install and AM installations. It is tapered to allow for sealant not to be forced out and to be thicker closer to the stack. The top has a detent that also holds sealant, to insure the all important stack seal is secure. Its wide enough to cover the largest of stack roof holes. The detent also serves as a foundation on AM installs when doing a existing vent conversion.