



### FIELD FIX FOR SKIPPING TEETH ON THROUGH-FRAME SLIDEOUTS

In the event that the gear pack binds, the INNER TUBE of the slideout may be pushed upward creating a condition the crowns or bends the top of the OUTER TUBE creating enough space that will allow the gear pack to periodically skip teeth. The following field fix remedies the occurrence:

1. Extend slideout room.
2. Locate the end of the slideout assembly where the gear pack is fastened. **Fig. 1**
3. Inspect top of OUTER TUBE for crowning (top center of tube is higher than top sides). **Fig. 1a**
4. If OUTER TUBE is crowned, tap portion of the WEAR TAB protruding from the top of the OUTER TUBE, down, be careful not to remove the WEAR TAB. **Fig. 2**
5. Take a 5/16" flat washer, **Fig. 3**, and remove a notch equal to the diameter of the hole, **Fig. 4**.
6. Slide the notched washer into the gap created when the WEAR TAB was tapped out. **Fig. 5**.
7. Slide a pry bar or screwdriver under the cap of the WEAR TAB and push it up to seat it properly into place.
8. Reset timing on the drive (actuator) side.
9. Remove front bolt from gear pack.
10. Loosen rear bolt in rear of gear pack and pull down on gear pack so it swings away from rack.
11. Push wall switch to extend or retract, whichever direction is lagging, to even room up.
12. Reposition gear pack and replace and tighten bolts.

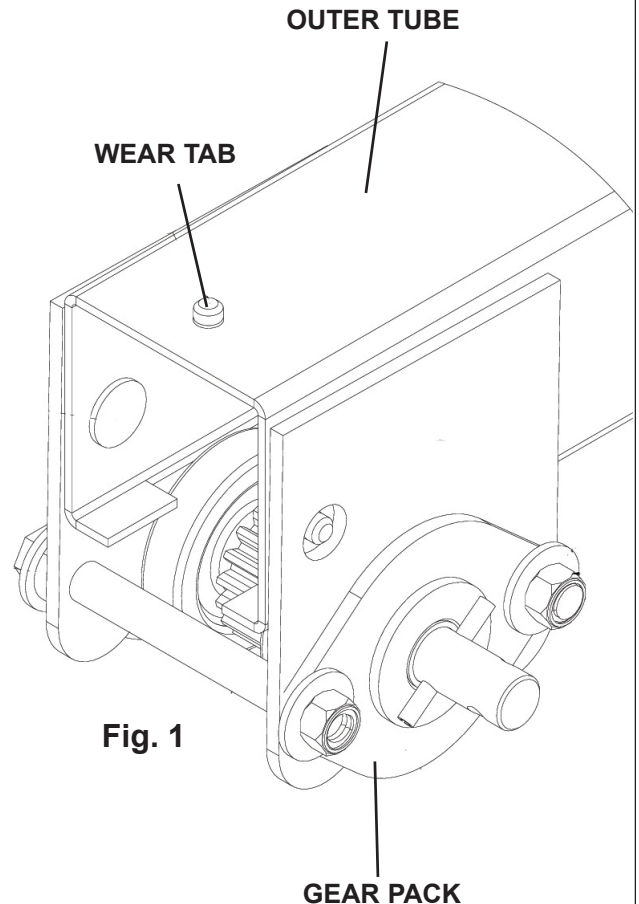

Fig. 1

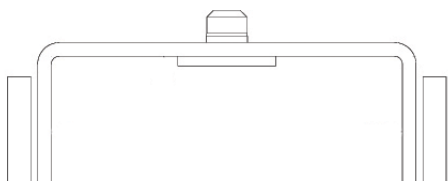

Fig. 1a

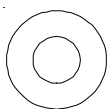

Fig. 3



Fig. 4

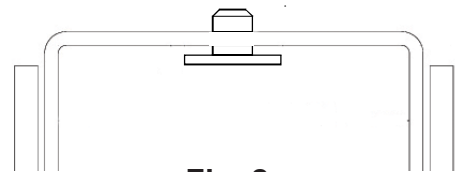

Fig. 2

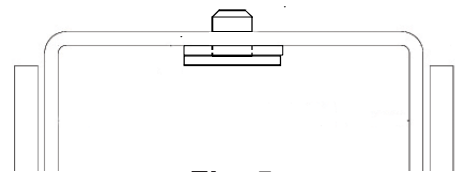

Fig. 5